



## MEDC Product Overview

World class manufacturers of alarm, signalling and notification products for use in hazardous and industrial areas

**COOPER** Notification



In today's intensely competitive marketplace, proven reliability and expertise combine with functionality to drive the ultimate purchasing decision. When you are working on a multi-million dollar construction project, you need a partner that can support you with tried-and-tested products as well as a full service and support package from initial system definition through to design and service. **Cooper MEDC** is dedicated to maximising both personnel and equipment safety by offering a comprehensive range of innovative notification solutions designed for potentially explosive atmospheres and harsh industrial and marine environments.

## Proven solutions for harsh and hazardous environments

Designers and manufacturers of alarm, signal, control and communications equipment since 1975, Cooper MEDC has developed a range of products specifically designed for harsh environmental conditions and where there is a risk of explosion due to the presence of flammable atmospheres both offshore and onshore. The extensive range of manual, visual, audible alarms and loudspeakers has been developed in close collaboration with customers to deliver the best combination of performance and safety. Through its vast global presence, technical sales force and engineering experts, Cooper MEDC meets the demanding standards of a multitude of industries including: oil, gas, petrochemical, marine and mining.

## Technical solutions and superior performance

Cooper MEDC has pioneered the use of glass reinforced polyester (GRP) in explosion-proof products to deliver solutions with reduced maintenance, extended lifetime and lower cost of ownership. Since 1975, the oil and gas industry has counted on Cooper MEDC for the most reliable and highly respected alarms and loudspeakers in the industry. Extensive quality certifications include ATEX, CQST, UL, ULC, CSA, GOST R, GOST K, IECEx and Inmetro and demonstrate our commitment to maintaining our leadership position in the market.

## Thousands of Products, Hundreds of Solutions, One Cooper

Within Cooper Industries' Safety division, Cooper MEDC's notification equipment is part of a comprehensive portfolio of solutions which also includes emergency lighting, security and fire detection as well as lighting fixtures and electrical installation materials.

Cooper Safety specialises in products designed to save lives and protect property in the most demanding industrial, residential and commercial environments worldwide. The company's high-quality brands have earned leadership positions in the markets we serve and that leadership is sustained through unparalleled sales support, market expertise and local availability. Cooper Safety is a division of Cooper Industries with manufacturing facilities in 23 countries and more than 25,000 people throughout the world.



## How to use this Overview

This overview contains concise information on **Cooper MEDC** products for use in potentially explosive atmospheres, harsh industrial and marine environments.

To use this guide, refer to the product group of interest, read through the brief information and select the specific product for your application.

For more detailed information visit our website [www.medc.com](http://www.medc.com) where a detailed datasheet can be downloaded. Or alternatively contact our sales offices in the UK and the USA for a full catalogue.



Manual Alarm Call Points	6
Status Lights	9
Beacon / Strobes	12
Sounders / Horns	20
Combination Units	24
Speakers	27
Detectors / Control / Distribution	31
Heavy Duty Industrial / Marine	35
North American Certified Products	38

# Hazardous Area Guide

This information is intended as a guide only and further expert guidance should be sought before placing into service, maintaining or repairing any item of equipment in a Potentially Explosive Atmosphere.

**Definition** | Potentially Explosive Atmospheres exist where there is a risk of explosion due to mixtures of gas/air, vapour/air, dust/air or other flammable combinations. Where electrical equipment has to be used in these areas, it must be so designed and constructed such that it does not create sources of ignition capable of igniting these mixtures.

**Area Classification** | Process plants are divided into Zones (European and IEC method) or Divisions (North American method) according to the likelihood of a Potentially Explosive Atmosphere being present. Note: North American legislation now allows Zones to be used to classify areas, where this practice is used it follows the IEC Zone method.

European & IEC Classification	Definition of zone or division	North American Classification
Zone 0 (gases) Zone 20 (dusts)	An area in which an explosive mixture is continuously present or present for long periods	Class I Division 1 (gases) Class II Division 1 (dusts)
Zone 1 (gases) Zone 21 (dusts)	An area in which an explosive mixture is likely to occur in normal operation	Class I Division 1 (gases) Class II Division 1 (dusts)
Zone 2 (gases) Zone 22 (dusts)	An area in which an explosive mixture is not likely to occur in normal operation and if it occurs it will exist only for a short time	Class I Division 2 (gases) Class II Division 2 (dusts) Class III Division 1 (fibres) Class III Division 2 (fibres)

## Gas Groups, Dusts and Fibres

There are two main gas groups, Group I – Mining only and Group II – Surface Industries.

These categories are used in European and I.E.C. groupings.

**Group I** is concerned only with underground mining where methane and coal dust are present.

**Group II** gases occurring in surface industries, are sub-grouped according to their volatility. This enables electrical equipment to be designed to less onerous tolerances if it is to be used with the least volatile gases.

Typical gas/ material	European/I.E.C. / North American	
	Gas Group	Gas Group
Methane	I	-
Acetylene	IIC	A
Hydrogen	IIC	B
Ethylene	IIB	C
Propane	IIA	D
Metal dust	-	E
Coal dust	-	F
Grain dust	-	G

## ATEX

After 1st July 2003, the ATEX directive came into force and is a mandatory requirement for all equipment intended for use in Potentially Explosive Atmospheres within the E.U. All relevant MEDC equipment is covered by the date it comes into force and many are already certified. It should be noted also that MECHANICAL equipment is covered by the ATEX directive so for the first time items such as gearboxes will have to carry ATEX certification.

## Temperature

To guard against hot surfaces igniting gases, all electrical equipment intended for use in Potentially Explosive Atmospheres is classified according to the maximum surface temperature it will reach in service (normally based on a surrounding ambient temperature of 40°C (102°F)).

Temperature Classification		Maximum Surface Temperature
European/I.E.C.	North American	
T1	T1	450° C
T2	T2	300° C
	T2A	280° C
	T2B	260° C
	T2C	230° C
	T2D	215° C
T3	T3	200° C
	T3A	180° C
	T3B	165° C
	T3C	160° C
T4	T4	135° C
	T4A	120° C
T5	T5	100° C
T6	T6	85° C

The equipment coding will be as the current practice plus an additional code as follows:

ExII2GD i.e.

Ex – Explosionproof in accordance with ATEX.

II – Group II surface industries

2 – Category 2 equipment (suitable for use in Zone 1) note:

Category 1 is suitable for Zone 0.

Category 3 is suitable for Zone 2.

G – suitable for atmospheres containing gas

D – suitable for atmospheres containing dust

Equipment will be CE marked when certified to ATEX.

**For more information about hazardous areas, download guide from [www.medc.com](http://www.medc.com).**

Types of Electrical Equipment Suitable for use in Potentially Explosive Atmospheres	European Area of use Designation Standard	IEC Area of use Designation Standard	USA Area of use Designation Standard
Different techniques are used to prevent electrical equipment from igniting explosive atmospheres. There are restrictions on where these different types of equipment can be used as follows:			
<b>Flameproof Enclosure</b> – An enclosure used to house electrical equipment, which when subjected to an internal explosion will not ignite a surrounding explosive atmosphere.	<b>Zones 1 &amp; 2</b> EExd EN60079-1	<b>Zones 1 &amp; 2</b> Exd IEC60079-1	<b>Class I Divisions 1 &amp; 2</b> – UL1203
<b>Intrinsic Safety</b> – A technique whereby electrical energy is limited such that any sparks or heat generated by electrical equipment is sufficiently low as to not ignite an explosive atmosphere.	<b>Zones 0, 1 &amp; 2</b> EExi EN60079-11	<b>Zones 1 &amp; 2</b> Exi IEC60079-11	<b>Class I Divisions 1 &amp; 2</b> – UL913
<b>Increased Safety</b> – This equipment is so designed as to eliminate sparks and hot surfaces capable of igniting an explosive atmosphere.	<b>Zones 1 &amp; 2</b> EExe EN60079-7	<b>Zones 1 &amp; 2</b> Exi IEC60079-7	– – –
<b>Purged and Pressurised</b> – Electrical equipment is housed in an enclosure which is initially purged to remove any explosive mixture, then pressurised to prevent ingress of the surrounding atmosphere prior to energisation.	<b>Zones 1 &amp; 2</b> EExp EN60079-2	<b>Zones 1 &amp; 2</b> Exp IEC60079-2	<b>Class I Divisions 1 &amp; 2</b> – NFPA496
<b>Encapsulation</b> – A method of exclusion of the explosive atmosphere by fully encapsulating the electrical components in an approved material.	<b>Zones 1 &amp; 2</b> EExm EN60079-18	<b>Zone 1 &amp; 2</b> Exm IEC60079-18	– – –
<b>Oil Immersion</b> – The electrical components are immersed in oil, thus excluding the explosive atmosphere from any sparks or hot surfaces.	<b>Zone 1 &amp; 2</b> EExo EN50015	<b>Zones 1 &amp; 2</b> Exo IEC60079-6	<b>Class I Division 2</b> – UL698
<b>Powder Filling</b> – Equipment is surrounded with a fine powder, such as quartz, which does not allow the surrounding atmosphere to come into contact with any sparks or hot surfaces.	<b>Zones 1 &amp; 2</b> EExq EN50017	<b>Zones 1 &amp; 2</b> Exq IEC60079-5	– – –
<b>Non-sparking</b> – Sparking contacts are sealed against ingress of the surrounding atmosphere, hot surfaces are eliminated.	<b>Zone 2</b> EExn EN60079-15	<b>Zone 2</b> Exn IEC60079-15	– – –

#### Selection, Installation and Maintenance of Electrical Equipment Intended for use in Potentially Explosive Atmospheres

International and national standards are published giving details of requirements for the safe use of Electrical Equipment in Potentially Explosive Atmospheres as follows:

	International	Europe	U.S.A.
General Recommendations	IEC60079-14	EN60079-14	N.E.C. Chapter 5
Classification of Hazardous Areas	IEC60079-10	EN60079-10	N.E.C. Chapter 5
Inspection and Maintenance of Electrical Equipment	IEC60079-17	EN60079-17	-
Requirements for Flameproof Enclosures	IEC60079-14	EN60079-14	N.E.C. Chapter 5
Requirements for Intrinsically Safe Equipment	IEC60079-14	EN60079-14	N.E.C. Chapter 5
Requirements for Increased Safety Equipment	IEC60079-14	EN60079-14	N.E.C. Chapter 5
Requirements for Purged and Pressurised Equipment	IEC60079-14	EN60079-14	N.E.C. Chapter 5
Requirements for Non-Sparking Equipment	IEC60079-14	EN60079-14	-

Cooper MEDC advise that all Explosion-proof electrical equipment is maintained, by suitably trained personnel, in accordance with the Manufacturers' recommendations.

Any spare parts used should be purchased from the original Manufacturer and repairs should be carried out by the Manufacturer or under his supervision, in order that the item remains in conformance with the certification documents.



## Manual Alarm Call Points

Cooper MEDC offer a range of manual alarm call points, in various materials covering push button and break glass versions.

Manual alarm call points are designed for the purpose of raising an alarm manually once verification of a fire or emergency condition exists, by operating the push button or break glass the alarm signal can be raised.

There are options for the inclusion of LED status indicators and addressable boards to give the unit an individually recognised location (or address) within the system. These manual call points are designed to meet European or North American industrial and fire application standards.



## Explosionproof & Weatherproof – Break Glass Call Point | **BG**

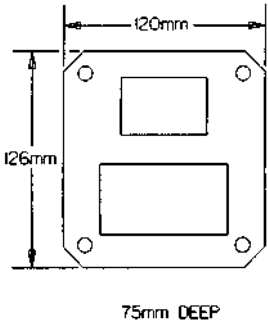

Certification	⊕ ATEX, UL, CSA, GOST 'R' & 'K', CQST, Inmetro, IECEx
Intrinsically Safe	ATEX Ex II 1GD, EExia IIC T4
Increased Safety	ATEX Ex II 2GD, EExed(m) IIC T4 (T6)
Area Classification	Model dependant - refer to datasheet
Certified Ambient Temperature	-40°C to +50°C (EExia) -20°C to +50°C (EExed)
Ingress Protection	IP66 & 67
Material	Corrosion-free GRP
Entries	Up to 4 x 20mm or 16mm (NPT for UL)
Weight	1.2kg (varies with model)
Options	Body colour, LED, lift flap, series & EOL resistors, diodes, earth continuity, terminals, certification, tag & duty labels.



Standard models.  
Available ex-stock.

Certification
ATEX Ex II 1GD
ATEX Ex II 2GD

Type
Intrinsically Safe
Increased Safety

Ordering Code
PX800002
PX800003

**Standard Product Configuration**  
Standard models have 2 x 20mm bottom entries, red painted GRP, single switch glass label 'Break Glass Press Here'.

## Explosionproof & Weatherproof – Break Glass Call Point | **BG2**

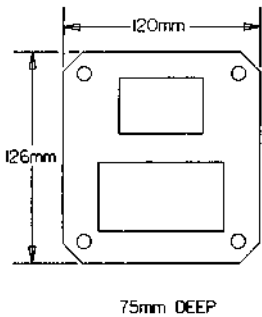

Certification	⊕ ATEX
Intrinsically Safe	ATEX Ex II 1GD, EExia IIC T4
Increased Safety	ATEX Ex II 2GD, EExed(m) IIC T4 (T6)
Area Classification	Model dependant - refer to datasheet
Certified Ambient Temperature	-40°C to +50°C (EExia) -20°C to +50°C (EExed)
Ingress Protection	IP66 & 67
Material	Corrosion-free GRP
Entries	2 x 20mm
Weight	1.2kg
Options	Lift flap, series & EOL resistors



Standard models.  
Available ex-stock.

Certification
ATEX Ex II 1GD
ATEX Ex II 2GD

Type
Intrinsically Safe
Increased Safety

Ordering Code
PX800005
PX800004

**Standard Product Configuration**  
Standard models have 2 x 20mm bottom entries, painted red GRP, single switch glass label 'Break Glass Press Here'.

## Explosionproof & Weatherproof – Break Glass Call Point | **BG3**

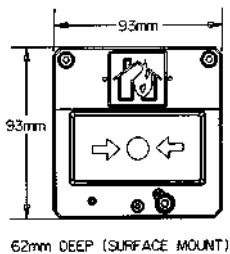

Certification	⊕ ATEX, CQST
Intrinsically Safe	ATEX Ex II 1G, EExia IIC T4
Area Classification	Model dependant - refer to datasheet
Certified Ambient Temperature	-55°C to +55°C (EExia)
Ingress Protection	IP66 & 67
Material	Corrosion-free GRP
Entries	2 x 20mm
Weight	0.5kg
Options	Body colour, LED, lift flap, series & EOL resistors, tag & duty labels.



Standard models.  
Available ex-stock.

Certification
ATEX Ex II 1G
-

Type
Intrinsically Safe
Weatherproof

Ordering Code
PX800007
PX800006

**Standard Product Configuration**  
Standard models are surface mount version, have 2 x 20mm bottom entries, painted red GRP, single switch glass label 'Break Glass Press Here', duty label 'Burning House'

## PB | Push Button Call Point – Explosionproof & Weatherproof



Certification	Ⓔ ATEX, UL, CSA, GOST 'R' & 'K', CQST, Inmetro, IECEx
Intrinsically Safe	ATEX Ex II 1GD, EExia IIC T4
Increased Safety	ATEX Ex II 2GD, EExed(m) IIC T4 (T6)
Area Classification	Model dependant - refer to datasheet
Certified Ambient Temperature	-40°C to +70°C (EExia) -20°C to +50°C (EExed)
Ingress Protection	IP66 & 67
Material	Corrosion-free GRP
Entries	Up to 4 x 20mm or 16mm (NPT for UL)
Weight	1.2kg
Options	Body colour, LED, series & EOL resistors, diode, earth continuity (Not UL), turn & push, self reset, tag & duty labels.

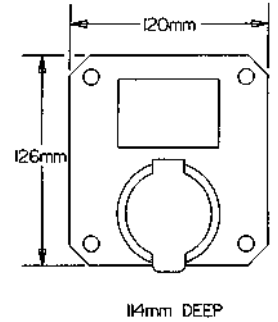

## SM87 BG | Break Glass Call Point – Explosionproof & Weatherproof



Certification	Ⓔ ATEX, CSA, GOST 'R' & 'K', CQST, Inmetro
Intrinsically Safe	ATEX Ex II 1G, EExia IIC T4
Flameproof	ATEX Ex II 2G, EExd IIC T6
Area Classification	Zone 0, Zone 1 and Zone 2 use*
Certified Ambient Temperature	-55°C to +70°C -20°C to +55°C (LED)
Ingress Protection	IP66 & 67
Material	Stainless Steel or Alloy
Entries	Up to 4 x 20mm or 25mm
Weight	3.8kg (Steel) 2.5kg (Alloy)
Options	Body colour, lift flap, LED, resistor, diode, 3 & 4 pole changeover switch, certification, tag & duty labels.

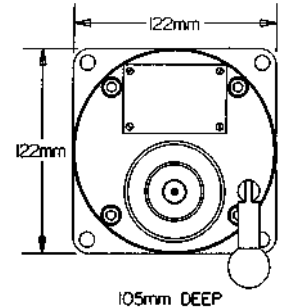

\*Depending on version.

## SM87 PB | Push Button Call Point – Explosionproof & Weatherproof



Certification	Ⓔ ATEX, UL, CSA, GOST 'R' & 'K', CQST, Inmetro
Intrinsically Safe	ATEX Ex II 1G, EExia IIC T4
Flameproof	ATEX Ex II 2G, EExd IIC T6
Area Classification	Zone 0, Zone 1 and Zone 2 use*
Certified Ambient Temperature	-55°C to +70°C -20°C to +55°C (LED)
Ingress Protection	IP66 & 67
Material	Stainless Steel or Alloy
Entries	Up to 4 x 20mm or 25mm (NPT for UL)
Weight	3.8kg (Steel) 2.5kg (Alloy)
Options	Body colour, LED, resistor, diode, 3 & 4 pole changeover switch, certification, tag & duty labels.

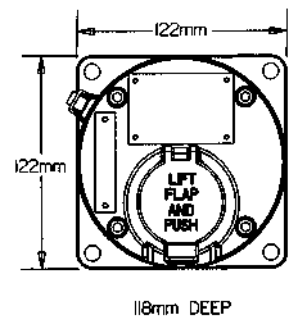

\*Depending on version.





## Status Lights

Cooper MEDC offer a range of Status Lights designed for potentially explosive atmospheres and harsh environmental conditions.

Status lights are commonly found in oil, gas, petrochemical and other hazardous areas where multicoloured lamp combinations are used to identify the safety status of specific zones.



# Status Lights

## SM87 SL | Xenon, Filament, Fluorescent & LED Status Lamps – Explosionproof & Weatherproof



Certification	⊕ ATEX, GOST 'R' & 'K', CQST, Inmetro, CSA
Flameproof	ATEX Ex II 2G, EExd IIC T4 (LED/Fil)
Area Classification	Zone 1 and Zone 2 use.
Certified Ambient Temperature	-20°C to +55°C (LED/Fil) -55°C to +70°C* (Xe/Fil)
Ingress Protection	IP66 & 67
Material	Stainless Steel or Alloy
Entries	Up to 3 x 20mm or 25mm
No. of Ways	Up to 4
Options	Body & lens colour, certification, tag & duty labels. *Model dependant, refer to data sheet.

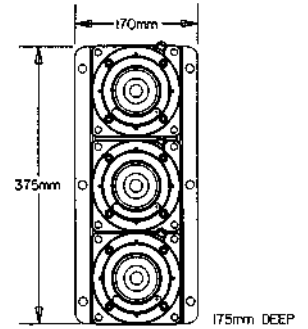

## SL5 | Xenon, Filament & LED Status Lights – Explosionproof & Weatherproof



Certification	⊕ ATEX, CQST
Increased Safety	ATEX Ex II 2G, EExe(m) II T3/T4
Area Classification	Zone 1 and Zone 2 use.
Certified Ambient Temperature	-40°C to +55°C (Xe/Fil) -40°C to +45°C (LED)
Ingress Protection	IP66 & 67
Material	Corrosion-free GRP
Entries	Up to 2 x 16mm or 20mm or 1 x 25mm or 32mm
No. of Ways	Up to 5
Options	Body & lens colour, certification, tag & duty labels.

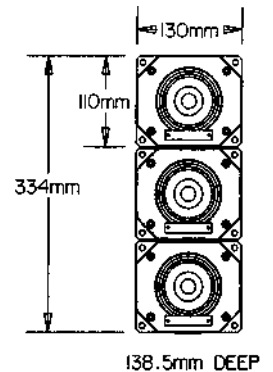

## SL15 Range | Status Lights – Explosionproof & Weatherproof



Certification	⊕ ATEX, and IEC Ex Approved, UL
Area Classification	Model dependant - refer to datasheet
Certified Ambient Temperature	-55°C to +70°C
Ingress Protection	IP66 & 67
Material	Corrosion-free GRP
Entries	Up to 2 x 1/2" or 2 x 3/4" entries. ATEX has M20 or M25.
No. of Ways	Up to 4
Options	Various flash rates available for xenon units. Various lens colours. Optional cast or wire lens guard.

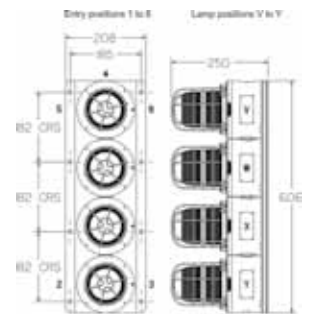

UL Version

*Explosionproof & Weatherproof*– Xenon, Filament & Flourescent Status Lamps | **XB11SL**

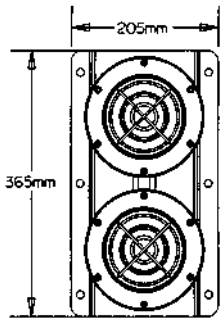

192mm DEEP

Certification	ATEX, UL, Inmetro, CQST
Flameproof	ATEX Ex II 2GD, EExd IIB T5/T6
Area Classification	Zone 1 and Zone 2 use.
Certified Ambient Temperature	-55°C to +70°C
Ingress Protection	IP66 & 67
Material	Corrosion-free GRP
Entries	1 x 20mm (NPT for UL)
No. of Ways	Up to 5
Options	Body & lens colour, tag & duty labels.



Status Lamps can also be configured using the high intensity XB4 range.

*Explosionproof & Weatherproof* – Xenon, Filament & Flourescent Status Lamp | **XB12SL**

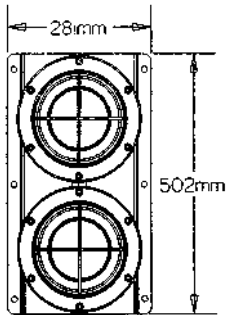

290mm DEEP

Certification	ATEX, UL, Inmetro, GOST, CQST
Flameproof	ATEX Ex II 2G, EExd IIB T4/T5
Area Classification	Model dependant - refer to datasheet
Certified Ambient Temperature	-55°C to +70°C
Ingress Protection	IP66 & 67
Material	Corrosion-free GRP
Entries	1 x 20mm (NPT forUL)
No. of Ways	Up to 5
Options	Body & lens colour, tag & duty labels.





## Beacons / Strobes

Cooper MEDC offer a range of beacons including flashing, steady-state indicators and rotating units. These may be used to warn of potential hazards or indicate the status of plant items, gas and oil leaks, evacuation alerts and many more.

The signals may operate as stand-alone units or be incorporated into a wider system, such as a fire panel. Within this section there is a wide variety of output values and lens colours.



## Explosionproof & Weatherproof – 5 Joule Flashing Xenon | **SM87 HXB**

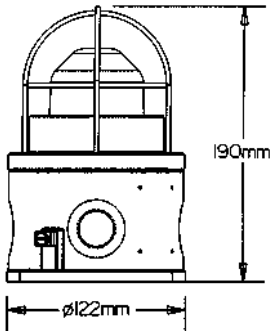

Standard models.  
Available ex-stock.

Certification	ATEX, UL, CSA, GOST 'R' & 'K', CQST, Inmetro
Flameproof	ATEX Ex II 2GD, EExd(e) IIC T4 & T6
Area Classification	Model dependant - refer to datasheet
Certified Ambient Temperature	-55°C to +70°C (EExd)
Ingress Protection	IP66 & 67
Material	Stainless Steel or Alloy
Entries	Up to 4 x 20mm or 25mm (NPT for UL)
Weight	3.8kg (Steel) or 2kg (Alloy)
Options	Body & lens colour, EOL resistor, tel. & relay initiate, lens guard, tag or duty labels, flash rate, high temp. version (-40°C to +85°C) available, voltages 24-48V d.c., 110-254V a.c.



Certification	Voltage	Lens Colour	Ordering Code
ATEX Ex II 2G	24V d.c.	Red	PX813005
ATEX Ex II 2G	24V d.c.	Amber	PX813006
ATEX Ex II 2G	240V a.c.	Red	PX813007
ATEX Ex II 2G	240V a.c.	Amber	PX813008

**Standard Product Configuration**  
Standard models are in alloy, red body, no tag or duty labels, 2 x M20 entries, 60 flashes per minute.

## Explosionproof & Weatherproof – 5 Joule Flashing Xenon | **XB11**

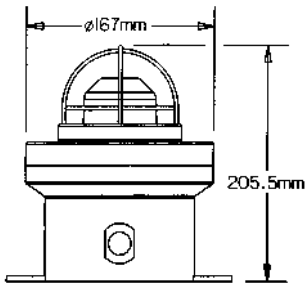

Standard models.  
Available ex-stock.

Certification	ATEX, UL, CQST, SAA, Inmetro, GOST 'R' & 'K', IECEx
Flameproof	ATEX Ex II 2GD, EExd IIB T4, T5 & T6
Area Classification	Zone 1 and Zone 2 use.
Certified Ambient Temperature	-55°C to +70°C
Ingress Protection	IP66 & 67
Material	Corrosion-free GRP
Entries	2 x 20mm (NPT for UL)
Weight	2.5kg
Options	Body & lens colour, mounting, tel. initiate, lens guard, flash rate, earth continuity, voltages 24V d.c., 110V a.c., 240 V a.c.



Certification	Voltage	Lens Colour	Ordering Code
ATEX Ex II 2GD	24V d.c.	Red	PX811101
ATEX Ex II 2GD	24V d.c.	Amber	PX811102
ATEX Ex II 2GD	240V a.c.	Red	PX811103
ATEX Ex II 2GD	240V a.c.	Amber	PX811104

**Standard Product Configuration**  
Standard models are in GRP, natural black body, no tag or duty labels, 2 x M20 entries, 60 flashes per minute.

## Explosionproof & Weatherproof – 5 Joule Flashing Xenon | **XB9**

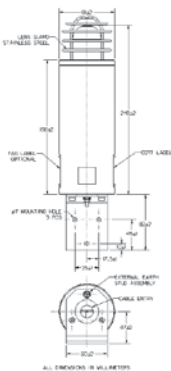

Standard models.  
Available ex-stock.

Certification	ATEX, Inmetro, IECEx
Flameproof	ATEX Ex II 2G, EExd IIC T5/T6
Area Classification	Zone 1 and Zone 2 use.
Certified Ambient Temperature	-55°C to +55°C
Ingress Protection	IP66 & 67
Material	Corrosion-free GRP
Entries	1 x 20mm or PG13.5
Weight	1.6kg
Options	Body & lens colour, tag or duty labels, voltages, flash rate, 24-48V d.c., 110-254V a.c.



Certification	Voltage	Lens Colour	Ordering Code
ATEX Ex II 2G	24V d.c.	Red	PX819105
ATEX Ex II 2G	24V d.c.	Amber	PX819106
ATEX Ex II 2G	240V a.c.	Red	PX819107
ATEX Ex II 2G	240V a.c.	Amber	PX819108

**Standard Product Configuration**  
Standard model has natural black body, no tag or duty labels, 60 flashes per minute, lens guard, 3m cable & tail.

## XB10 | 10 & 15 Joule Flashing Xenon – Explosionproof & Weatherproof



Certification	⊕ ATEX, GOST 'R', Inmetro, IECEX
Flameproof	ATEX Ex II 2G, EExd(e) IIB T4
Area Classification	Zone 1 and Zone 2 use.
Certified Ambient Temperature	*-55°C to +55°C 10 Joule *-55°C to +40°C 15 Joule
Ingress Protection	IP66 & 67
Material	Corrosion-free GRP
Entries	Up to 3 x 20mm or 2 x PG13.5
Weight	EExd 2.8kg EExde 3.6kg
Options	Body & lens colour, tel. initiate, earth continuity, flash rate, terminal chamber, voltages 24-48V d.c., 110-254V a.c.

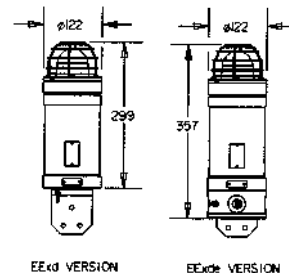

\*EExd version only, see data sheet for more information.

Standard models.  
Available ex-stock.

Certification	Voltage	Lens Colour	Ordering Code
ATEX Ex II 2G	24V d.c.	Red	PX811050
ATEX Ex II 2G	24V d.c.	Amber	PX811051
ATEX Ex II 2G	240V a.c.	Red	PX811052
ATEX Ex II 2G	240V a.c.	Amber	PX811053

### Standard Product Configuration

Standard models are in natural black, 15 Joules, lens guard, no tag or duty labels, 2 x M20 entries, 60 flashes per minute.

## XB16 | 10 Joule Flashing Xenon – UL Hazardous & Ordinary Locations



Certification	UL (1971 compliant)
Hazardous Locations	Class I, Div 2, Groups A-D Class II, Div 2, Groups F & G
Area Classification	Model dependant - refer to datasheet
Certified Ambient Temperature	Certified Ambient Temperature -55°C to +70°C
Ingress Protection	IP66 & 67
Material	Corrosion-free GRP
Entries	1 x 3/4" NPT
Weight	1kg
Options	Body & lens colour, lens guard, tag & duty labels, relay initiate, flash rate, voltages 12-48V d.c., 110-254V a.c.

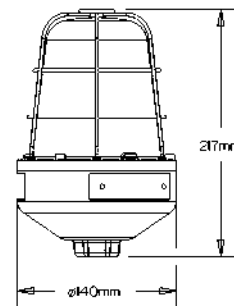

## XB15 | 15 Joule Flashing Xenon – Explosionproof & Weatherproof



Certification	⊕ ATEX, UL, Inmetro, ULC, IECEX
Flameproof	ATEX Ex II 2GD, EExd IIC T4, T5 & T6
Area Classification	Zone 1 and Zone 2 use.
Certified Ambient Temperature	-55°C to +70°C
Ingress Protection	IP66 & 67
Material	Corrosion-free GRP
Entries	Up to 3 x 20mm or 3 x 25mm (NPT for UL)
Weight	2.6-3kg
Options	Body & lens colour, relay & telephone initiate, flash rate, voltages 12-48V d.c., 110-254V a.c.

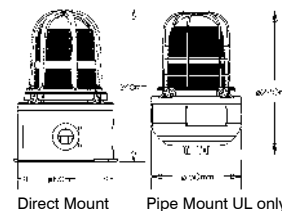

## Explosionproof & Weatherproof – 21 Joule Flashing Xenon | **XB4**

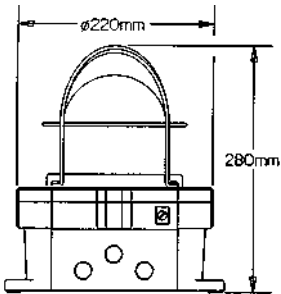

Certification	ATEX, UL, GOST 'R', SAA, Inmetro
Flameproof	ATEX Ex II 2G, EExd(e) IIC T5
Area Classification	Zone 1 and Zone 2 use.
Certified Ambient Temperature	-55°C to +70°C
Ingress Protection	IP66 & 67
Material	Stainless Steel or Alloy
Entries	Up to 4 x 20mm or 25mm
Weight	15-16kg (Steel), 6.6-7.6kg (Alloy)
Options	Body & lens colour, lens guard, tag & duty labels, terminal chamber, initiation options, flash rate, voltages 24-48V d.c., 110-254V a.c.



Standard models.  
Available ex-stock.

Certification	Voltage	Lens Colour	Ordering Code
ATEX Ex II 2G	24V d.c.	Red	PX814001
ATEX Ex II 2G	240V a.c.	Red	PX814002

**Standard Product Configuration**  
Standard model are red painted, alloy, no lens guard, 2 x M20 entries.

## Explosionproof & Weatherproof – 21 Joule Flashing Xenon | **XB12**

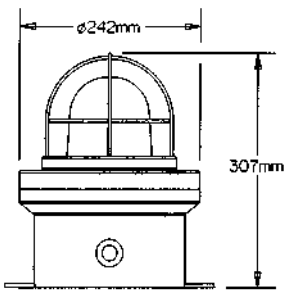

Certification	ATEX, UL, GOST 'R' & 'K', CQST, Inmetro, IECEx
Flameproof	ATEX Ex II 2G, EExd IIB T4/T5
Area Classification	Zone 1 and Zone 2 use.
Certified Ambient Temperature	-55°C to +70°C
Ingress Protection	IP66 & 67
Material	Corrosion-free GRP
Entries	2 x 20mm (NPT for UL)
Weight	7.0kg
Options	Body & lens colour, lens guard, tag & duty labels, telephone initiation, flash rate, mounting method, earth continuity, voltages 24V d.c., 110-240V a.c.



Standard models.  
Available ex-stock.

Certification	Voltage	Lens Colour	Ordering Code
ATEX EX II 2GD	24V d.c.	Red	PX812101
ATEX EX II 2GD	24V d.c.	Amber	PX812102
ATEX EX II 2GD	240V a.c.	Red	PX812103
ATEX EX II 2GD	240V a.c.	Amber	PX812104

**Standard Product Configuration**  
Standard models are in natural black GRP, no lens guard, 2 x 20mm entries, 60 flashes per minute.

## Explosionproof & Weatherproof – 0.5 Joule Flashing Xenon | **XB8**

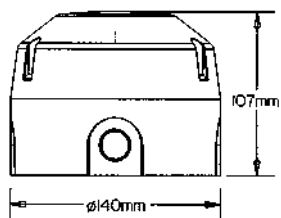

Certification	ATEX GOST 'R'
Intrinsically Safe	ATEX Ex II 1G, EExia IIB/IIC T4
Area Classification	Zones 0, 1, 2 & safe area use.
Certified Ambient Temperature	-55°C to +60°C
Ingress Protection	IP66 & 67
Material	Corrosion-free GRP body, Polycarbonate lens
Entries	Up to 3 x 20mm via knockouts
Weight	1.4kg
Options	Body & lens colour, certification, tag & duty labels, voltages 12-24V d.c.



Standard models.  
Available ex-stock.

Certification	Voltage	Lens Colour	Ordering Code
ATEX Ex II 1G	24V d.c.	Clear	PX818002

**Standard Product Configuration**  
Standard models have painted red body colour, no tag or duty labels, 60 flashes per minute.

## XB13 | 10 Joule Flashing Xenon – Weatherproof & Heavy Duty



Area Classification	<b>Weatherproof.</b>
Operating Temperature	<b>-55°C to +70°C</b>
Ingress Protection	<b>IP66 &amp; 67</b>
Material	<b>Corrosion-free GRP body Polycarbonate lens</b>
Entries	<b>Up to 3 x 20mm via knockouts</b>
Weight	<b>1.1kg</b>
Options	<b>Body &amp; lens colour, tag &amp; duty labels, lens guard, telephone &amp; relay initiate, single &amp; dual flash mode, voltages 12 or 24V DC, 115 or 230V AC.</b>

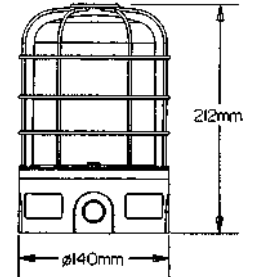

Standard models.  
Available ex-stock.

Voltage	Lens Colour	Ordering Code
24V d.c.	Red	PX813101
24V d.c.	Amber	PX813102
230V a.c.	Red	PX813103

### Standard Product Configuration

Standard models are in painted red body colour, no tag or duty labels, no lens guard, 3 x 20mm entries via knockouts, 60 flashes per minute (single flash mode), dual & single flash modes.

## SM87 | LU1/LU3 10 Watt Steady Filament/Fluorescent – Explosionproof & Weatherproof



Certification	<b>ATEX, UL, CSA, CQST, Inmetro, GOST 'R' &amp; 'K'</b>
Flameproof	<b>ATEX Ex II 2GD, EExd(e) IIC T4/T6</b>
Area Classification	<b>Zone 1 and Zone 2 use.</b>
Certified Ambient Temperature	<b>*-55°C to +55°C</b>
Ingress Protection	<b>IP66 &amp; 67</b>
Material	<b>Stainless Steel or Alloy</b>
Entries	<b>Up to 3 x 20mm or 25mm (NPT for UL)</b>
Weight	<b>2.5 - 3.8kg</b>
Options	<b>Body &amp; lens colour, lens guard, tag or duty labels, terminal chamber, voltages 24-48V d.c., 110-254V a.c.</b>

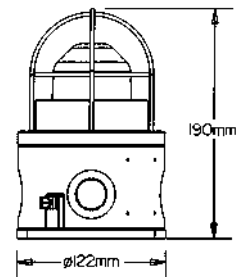

\* Model dependent

## FB11 & FL11 | 10 Watt Steady Filament & Fluorescent – Explosionproof & Weatherproof



Certification	<b>ATEX, UL, Inmetro, GOST 'R'</b>
Flameproof	<b>ATEX Ex II 2GD, EExd IIB T4/T5</b>
Area Classification	<b>Zone 1 and Zone 2 use.</b>
Certified Ambient Temperature	<b>-20°C to +55°C (FB11)</b>
Ingress Protection	<b>IP66 &amp; 67</b>
Material	<b>Corrosion-free GRP</b>
Entries	<b>2 x 20mm (NPT for UL)</b>
Weight	<b>2.8kg</b>
Options	<b>Body &amp; lens colour, lens guard, tag &amp; duty labels, lamp wattage, unit fixing, earth continuity, mounting method, voltages 24-48V d.c., 110-254V a.c.</b>

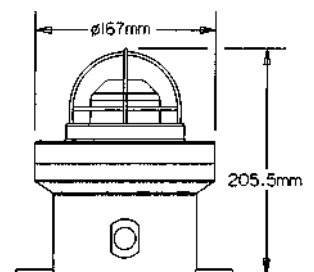



*Explosionproof & Weatherproof – 100 Watt Steady Filament & 39 Watt Fluorescent* | **FB4 & FL4**

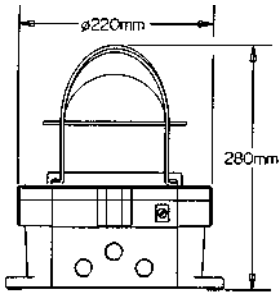

Certification	ATEX, UL, GOST 'R', Inmetro
Area Classification	Zone 1 and Zone 2 use.
Flameproof	ATEX Ex II 2G, EExd(e) IIC T3/T6
Certified Ambient Temperature	-55°C to +55°C (FB4 EExd) -50°C to +55°C (FB4 EExde) -20°C to +55°C (FL4)
Ingress Protection	IP66 & 67
Material	Stainless Steel or Alloy
Entries	Up to 4 x 20mm or 25mm
Weight	14.9-17.3kg (Steel), 6.5 - 8.9kg (Alloy)
Options	Body & lens colour, lens guard, tag & duty labels, lamp wattage, relay initiate or terminal chamber, voltages 24-48V d.c., 110V d.c., 110-254V a.c.



*Explosionproof & Weatherproof – 100 Watt Steady Filament & 39 Watt Fluorescent* | **FB12 & FL12**

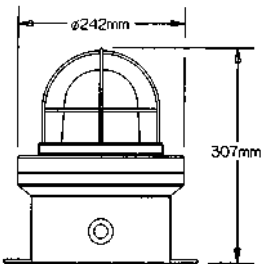

Certification	ATEX, UL, GOST 'R', Inmetro
Flameproof	ATEX Ex II 2G, EExd IIB T4/T5
Area Classification	Zone 1 and Zone 2 use.
Certified Ambient Temperature	-55°C to +55°C (FB12) -20°C to +55°C (FL12)
Ingress Protection	IP66 & 67
Material	Corrosion-free GRP
Entries	2 x 20mm (NPT for UL)
Weight	7.2 - 7.6kg
Options	Body & lens colour, lens guard, tag & duty labels, lamp wattage, unit fixing, earth continuity, mounting method, voltages 24-48V d.c., 110-254V a.c.



*Explosionproof & Weatherproof – 60 Watt Steady Filament* | **FB15**

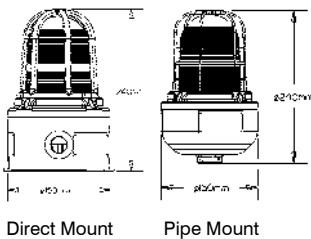

Certification	ATEX, UL, Inmetro, GOST 'R', IECEx
Flameproof	ATEX Ex II 2GD, AExd IIC T3/T4
Area Classification	Zone 1 and Zone 2 use.
Certified Ambient Temperature	-55°C to +70°C
Ingress Protection	IP66 & 67
Material	Corrosion-free GRP
Entries	2 x 20mm (NPT for UL)
Weight	2.6 Kg (Pipe Mount) 3.0 Kg (Direct Mount)
Options	Body & lens colour, lens guard, tag & duty labels, lamp wattage, unit fixing, mounting method, voltages 24-48V d.c., 110-254V a.c.



## FB5 & FL5 | 200 Watt Steady Filament & 52 Watt Steady Fluorescent – Explosionproof & Weatherproof



Certification	<b>ATEX</b>
Flameproof	<b>ATEX Ex II 2G, EExd(e) IIB T3/T4</b>
Area Classification	<b>Zone 1 and Zone 2 use.</b>
Certified Ambient Temperature	<b>-20°C to +30°C (FB5) -20°C to +50°C (FL5)</b>
Ingress Protection	<b>IP66, 67 &amp; 68</b>
Material	<b>Stainless Steel or Alloy</b>
Entries	<b>Up to 4 x 20mm or 25mm</b>
Weight	<b>11.6 - 14.3kg</b>
Options	<b>Body colour, lens guard, mounting method, voltages 220-254V a.c.</b>

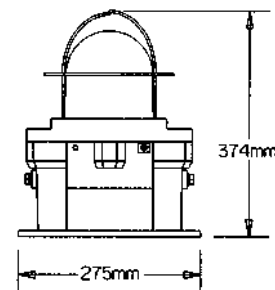

## SM87 LED | Up to 192 Cd Steady or Flashing LED (Selectable) – Explosionproof & Weatherproof



Certification	<b>ATEX, UL, GOST, Inmetro, CSA, CQST, GOST 'R' &amp; 'K'</b>
Flameproof	<b>ATEX Ex II 2GD, EExd(e) IIC T6</b>
Area Classification	<b>Zone 1 and Zone 2 use.</b>
Certified Ambient Temperature	<b>-20°C to +40°C</b>
Ingress Protection	<b>IP66 &amp; 67</b>
Material	<b>Stainless Steel or Alloy</b>
Entries	<b>Up to 3 x 20mm or 25mm</b>
Weight	<b>2.5 - 4.5kg</b>
Options	<b>Body &amp; lens colour, lens guard, tel &amp; relay initiate, EOL resistor, terminal chamber, voltages 24-48V d.c..</b>

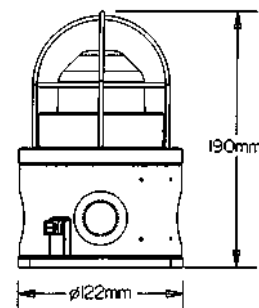

Energy efficient LED product

## XB5 & TH5 | 5 Joule Sequenced & 70 Watt Rotating – Explosionproof & Weatherproof



Certification	<b>ATEX</b>
Flameproof	<b>ATEX Ex II 2G, EExd(e) IIB T4/T6</b>
Area Classification	<b>Zone 1 use.</b>
Certified Ambient Temperature	<b>-20°C to +55°C (TH5) -20°C to +40°C (XB5)</b>
Ingress Protection	<b>IP66, 67 &amp; 68</b>
Material	<b>Alloy</b>
Entries	<b>Up to 4 x 20mm or 25mm – Exe only</b>
Weight	<b>14.6 - 15.9kg</b>
Options	<b>Body &amp; lens colour, lens guard, tag label, terminal chamber, rotational speed, voltages *12-48V d.c., 110-254V a.c.</b>

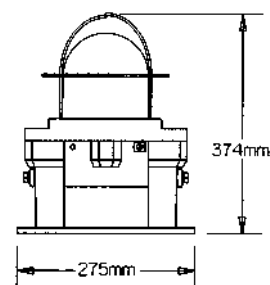

\*See datasheet for voltage option for TH5.

*Explosionproof & Weatherproof – 70 Watt Sodium/80 Watt Mercury Fluorescent* | **HS5 & MF5**

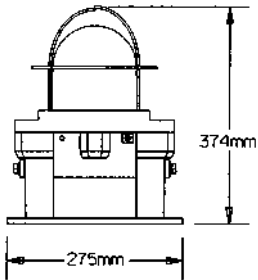

Certification	ATEX, CSA (HS5 only)
Flameproof	ATEX Ex II 2G, EExd(e) IIB T3/T4
Area Classification	Zone 1 and Zone 2 use.
Certified Ambient Temperature	-20°C to +40°C
Ingress Protection	IP66, 67 & 68
Material	Stainless Steel or Alloy
Entries	Up to 4 x 20mm or 25mm
Weight	12.9 - 14.0kg
Options	Body colour, lens guard, tag label, terminal chamber, mounting method, voltages 220-254V a.c.



*Explosionproof & Weatherproof – 55 Watt/70 Watt Rotating Beacon* | **TH12**

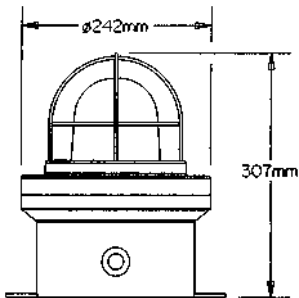

Certification	ATEX, GOST 'R', Inmetro
Flameproof	ATEX Ex II 2G, EExd IIB T4/T5
Area Classification	Zone 1 and Zone 2 use.
Certified Ambient Temperature	-55°C to +70°C T4
Ingress Protection	IP66 & 67
Material	Corrosion-free GRP
Entries	2 x 20mm
Weight	7.6kg
Options	Body & lens colour, lens guard, tag & duty labels, flash rate, mounting method, earth continuity, voltages 24V d.c. 110-240V a.c.





## Sounders / Horns

Cooper MEDC Sounders and Horns feature a variety of tone settings, voice messaging or traditional bells. Sounders and Horns are used to warn of potentially dangerous situations or to relay instructions.

In addition the alarms may operate as stand-alone units or be incorporated into a hazard warning system. A wide variety of sound output levels and other options are also available. The Sounders and Horns output in dB(A) is measured to European standards at 1 metre.



## Explosionproof & Weatherproof – 113dB(A) Sounder | DB1

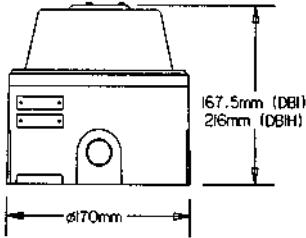

Certification	Ⓔ ATEX, UL, GOST 'R', SAA, Inmetro, IECEx
Flameproof	ATEX Ex II 2G, EExd IIB T3
Area Classification	Zone 1 and Zone 2 use.
Certified Ambient Temperature	-20°C to +70°C
Ingress Protection	IP66
Material	Stainless steel or alloy
Entries	Up to 3 x 20mm or 25mm
Weight	*3.5-12.7kg
Options	Body colour, tag & duty labels, two stage (DB1P) alarms, high output (DB1HP), tel, relay or remote initiate, EOL resistor, certification, voltages 12-48V d.c., 110V a.c., 240V a.c.



\*Model dependent

Standard models.  
Available ex-stock.

<b>Certification</b>	<b>Ordering Code</b>
ATEX Ex II 2G	PX801001

### Standard Product Configuration

Standard model is single stage alarm, red painted alloy, no tag or duty labels, 2 x M20 entries, 24V d.c., 6 tones, 103dBA output.

## Explosionproof & Weatherproof – 118dB(A) Sounder | DB3

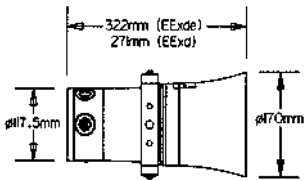

Certification	Ⓔ ATEX, UL, GOST 'R' & 'K', CQST, SAA, Inmetro
Flameproof	ATEX Ex II 2GD, EExd(e) IIC T5
Area Classification	Zone 1, Zone 2 and non-Ex use.
Certified Ambient Temperature	-20°C to +70°C (standard) -55°C to +55°C (low temp unit)
Ingress Protection	IP66 & 67
Material	Corrosion-free GRP
Entries	Up to 2 x 20mm
Weight	5.0kg
No. of Tones	27 user selectable tones and 5 optional programmable spaces.
Options	Body colour, tag & duty labels, two stage alarm (DB3P), low temperature version available, EOL resistor, certification, terminal chamber voltages 12-48V d.c., 110V-254V a.c.



Standard models.  
Available ex-stock.

Certification	Body Colour	Alarm Type	Voltage	Ordering Code
ATEX Ex II 2GD	Natural Black	Two Stage	12-48V d.c.	PX803121
ATEX Ex II 2GD	Red	Two Stage	12-48V d.c.	PX803123
ATEX Ex II 2GD	Red	Single Stage	12-48V d.c.	PX803125
ATEX Ex II 2GD	Natural Black	Single Stage	240V a.c.	PX803122
ATEX Ex II 2GD	Red	Single Stage	240V a.c.	PX803124

### Standard Product Configuration

Standard model has 27 tones, no tag or duty labels, 2 x 20mm entries with one certified plug fitted.

## Explosionproof & Weatherproof – 110dB(A) Voice Sounder | DB3V

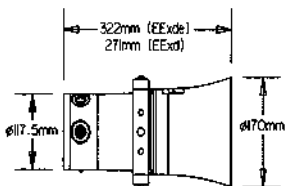

Certification	Ⓔ ATEX, UL, GOST 'R' & 'K', CQST, SAA, Inmetro
Flameproof	ATEX Ex II 2GD, EExd(e) IIC T5
Area Classification	Zone 1, Zone 2 and non-Ex use.
Certified Ambient Temperature	-20°C to +55°C (standard) -55°C to +55°C (low temp unit)
Ingress Protection	IP66 & 67
Material	Corrosion-free GRP
Entries	Up to 2 x 20mm
Weight	5.0kg
Speech Duration	Up to 20 seconds repeatable
Options	Body colour, tag & duty labels, low temperature version available, EOL resistor, record feature, certification, terminal chamber, 'mechanical bell' sound version, voltages 12-48V d.c.



## DB5 | 103dB(A) Sounder – Explosionproof & Weatherproof



Certification	⊕ ATEX, CSA, FM Approved, Inmetro, IECEx
Intrinsically Safe	ATEX Ex II 1G & Ex1 M1, EExia IIC T4
Area Classification	Zone 0, Zone 1 and Zone 2 use.
Certified Ambient Temperature	-20°C to +55°C
Ingress Protection	IP65
Material	Corrosion-free ABS
Entries	Up to 2 x 20mm via knockouts
Weight	0.3kg
No. of Tones	26
Options	Body colour, tag labels, certification, voltages 12V-24V d.c.

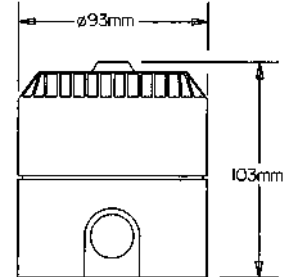

Standard models.  
Available ex-stock.

**Certification**  
ATEX Ex II 1G  
ATEX Ex II 1G

**Voltage**  
12V d.c.  
24V d.c.

**Ordering Code**  
PX805001  
PX805002

**Standard Product Configuration**  
Standard model has 26 tones, natural red body colour, no tag or duty labels, 2 x 20mm entries via knockouts.

## DB7 | 110dB(A) Sounder – Explosionproof & Weatherproof



Certification	⊕ ATEX GOST 'R'
Intrinsically	ATEX Ex II 1G, EExia IIB/IIC T4
Area Classification	Zones 0, 1, 2 and safe area use.
Certified Ambient Temperature	-55°C to +70°C
Ingress Protection	IP66 & 67
Material	Corrosion-free GRP
Entries	Up to 3 x 20mm via knockouts
Weight	1.0kg
No. of Tones	27
Options	Certification, body colour, duty & tag labels, voltages 12-24V d.c.

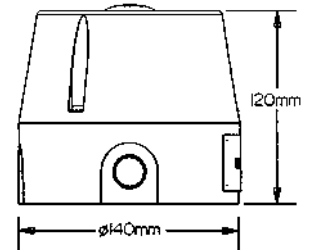

Standard models.  
Available ex-stock.

**Certification**  
ATEX Ex II 1G

**Voltage**  
24V d.c.

**Ordering Code**  
PX807006

**Standard Product Configuration**  
Standard model is a two stage alarm (DB7P), has 27 tones, painted red body, up to 3 x 20mm entries via knockouts.

## DB12 | 110dB(A) Sounder – Weatherproof & Heavy Duty



Area Classification	Weatherproof.
Operating Temperature	-55°C to +70°C
Ingress Protection	IP66 & 67
Material	Corrosion-free GRP
Entries	Up to 3 x 20mm via knockouts
Weight	1kg
No. of Tones	27 + 5 programmable
Options	Body colour, tag & duty labels, voltages 12V & 24V d.c.

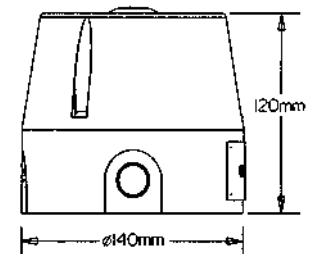

Standard models.  
Available ex-stock.

**Voltage**  
24V d.c.  
115/230V a.c.

**Alarm Type**  
Two Stage  
Single Stage

**Ordering Code**  
PX808001  
PX808003

**Standard Product Configuration**  
Standard model has 27 tones, painted red body colour, no tag or duty labels, 3 x 20mm entries via knockouts.

## Weatherproof & Heavy Duty – 117dB(A) Sounder | **DB15**

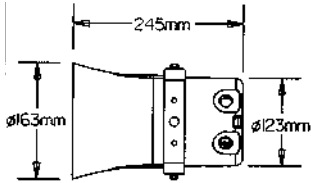

Area Classification	<b>Weatherproof.</b>
Operating Temperature	<b>-55°C to +70°C</b>
Ingress Protection	<b>IP66 &amp; 67</b>
Material	<b>Corrosion-free GRP</b>
Entries	<b>2 x 20mm</b>
Weight	<b>2.6kg</b>
No. of Tones	<b>27 + 5 programmable</b>
Options	<b>Painted grey, tag &amp; duty labels, two stage alarm (DB15P) version, earth continuity, EOL resistor, voltages 12-48V d.c., *110-254V a.c.</b>



\*Not available in a.c. versions for DB15P.

Standard models.  
Available ex-stock.

Voltage	Body Colour	Alarm Type	Ordering Code
24-48V d.c.	Grey	Two stage	PX808110
24-48V d.c.	Red	Two stage	PX808115
240V a.c.	Grey	Single stage	PX808120
240V a.c.	Red	Single stage	PX808125

### Standard Product Configuration

Standard model has 27 tones, 2 x 20mm entries.

## Explosionproof & Weatherproof – 109dB(A) Bell | **DB6**

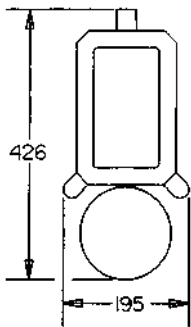

85mm DEEP

Certification	<b>ATEX, Inmetro, IECEx</b>
Flameproof	<b>ATEX Ex II 2G, EExd IIB T5</b>
Area Classification	<b>Zone 1 and Zone 2 use.</b>
Certified Ambient Temperature	<b>-20°C to +55°C</b>
Ingress Protection	<b>IP65</b>
Material	<b>Cast Iron</b>
Entries	<b>2 x 20mm</b>
Weight	<b>11kg</b>
Options	<b>Body colour, tag labels, voltages 24V d.c., 240V a.c.</b>



Standard models.  
Available ex-stock.

Certification	Voltage	Body Colour	Ordering Code
ATEX Ex II 2G	24V d.c.	Red	PX806003

### Standard Product Configuration

Standard models are in cast iron, no tag or duty labels, 2 x M20 entries.



## Combination Units

Cooper MEDC combination units are designed for the purpose of alerting audio and visual awareness to an emergency situation.

Our range of combination units are suitable for use in harsh environmental conditions found offshore and onshore in the oil, gas and petrochemical industries.





## Combination Beacon / Sounder | CU 1

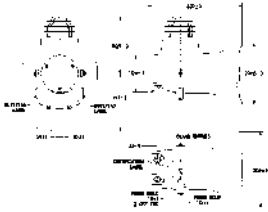

Standard models.  
Available ex-stock.

Certification	⊕ ATEX Ex II 2G, EExd(e)
Flameproof	IIB T3
Area Classification	Zone 1, Zone 2 & non-Ex use.
Certified Ambient Temperature	-50°C to +70°C*
Ingress Protection	IP66 & 67
Material	Corrosion-free GRP
Entries	Up to 2 x 25mm
Weight	6.5kg approx
Options	Body & lens colour, tel. initiate, earth continuity, flash rate, voltages 24-48V d.c. 110-254V a.c.



\*High Temperature Unit, See data sheet for other versions.

<b>Certification</b>
ATEX Ex 2GD
ATEX Ex 2GD
ATEX Ex 2GD

<b>Voltage</b>
24V d.c.
24V d.c.
240V d.c.

<b>Alarm Type</b>
Single Stage
Two Stage
Single Stage

<b>Lens Colour</b>	<b>Ordering Code</b>
Red	803140
Red	803141
Red	803142

### Standard Product Configuration

Standard models are in red finish, 10 Joules, lens guard, no tag or duty labels, 2 x M20 entries, one certified plug 60 flashes per minute.

## Explosionproof — Xenon 5J; Sounder | DB3 / XB11

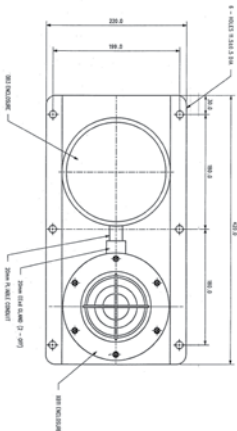

Certification	⊕ ATEX: Ex II 2GD, EExdIIBT5.
Area Classification	UL: Class I, Div. 1, Groups C & D.
Voltage	Model dependant - refer to datasheet
Beacon	24V d.c., 110V a.c., 240V a.c.
Sounder	Standard: XB11 (Xenon 5J). Option: Filament (10W). Fluorescent (≤10W).
Dimensions (mm)	Standard: DB3 (long flare) ≤115dBA at 1 metre. Option: DB3 (short flare) ≤108dBA at 1 metre.
Options	420 (height) x 220 (width) x 337 (depth). Refer to data sheet. Specify when ordering.



### Ordering Information — Standard product Specify options 1 – 4

Product	1. Certification	2. Voltage	3. Lens colour	4. Finish
DB3 + XB11	+ ATEX UL	+ see above	+ Red Amber	+ Natural Black Red

## Explosionproof — Xenon 5J; Sounder | DB1 HP / SM87 HXB

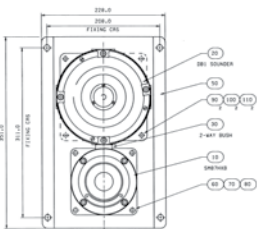

Certification	⊕ ATEX: Ex II 2G, EExdIIBT4(T3).
Area Classification	UL: Class I, Div. 1, Groups C & D.
Voltage	Model dependant - refer to datasheet
Beacon	24V d.c., 110V a.c., 240V a.c.
Sounder	Standard: SM87 (Xenon 5J). Option: Filament (10W). Fluorescent (≤10W).
Dimensions (mm)	Standard: DB1 P ≤ 106dBA at 1 metre Option: DB1 HP ≤ 110dBA at 1 metre
Options	351 (height) x 228 (width) x 205 (depth). Refer to data sheet. Specify when ordering.



### Ordering Information — Standard product Specify options 1 – 5

Product	1. Body Material	2. Certification	3. Voltage	4. Lens colour	5. Finish
DB1 P + SM87HXB	+ LM25 stainless steel	+ ATEX UL	+ see above	+ Red Amber	+ specify

## DB3 / SM87 HXB | Xenon 5J; Sounder — *Explosionproof*



Certification	ATEX: Ex II 2G, EExdIIC5. UL: Class I, Div. 2, Groups C & D.
Area Classification	Model dependant - refer to datasheet
Voltage	24V d.c., 48V d.c., 240V a.c.
Beacon	LM25 or stainless steel.
Sounder	Corrosion-free GRP.
Beacon	Standard: SM87 (Xenon 5J). Option: Filament (10W). Flourescent ( $\leq 10W$ ). LED ( $\leq 192cd$ )
Sounder	Standard: DB3 (long flare) $\leq 115dB(A)$ at 1 metre. Option: DB3 (short flare) $\leq 108dB(A)$ at 1 metre (Note: Close coupled unit only available ATEX certified).
Dimensions (mm)	420 (height) x 220 (width) x 337 (depth).
Options	Refer to data sheet. Specify when ordering.

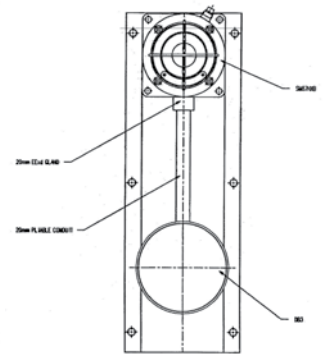

### Ordering Information — Standard product Specify options 1 – 5

Product	1. Body Material	2. Certification	3. Voltage	4. Lens colour	5. Finish
DB3 / SM87 HXB	+ LM25 stainless steel	+ ATEX UL	+ see above	+ Red Amber	+ specify

## DB12 / XB13 | Heavy Duty Industrial Marine Xenon 10J



Applications	Harsh Industrial & Marine Environments.
Area Classification	Model dependant - refer to datasheet
Voltage	12V, 24V d.c., 110V, 240V a.c.
Beacon	Standard: XB13 (Xenon 10J).
Sounder	Standard: DB12 110dB(A) at 1 metre. Standard: DB15 115dB(A) at 1 metre.
Dimensions (mm)	300 (height) x 195 (width) x 220 (depth).

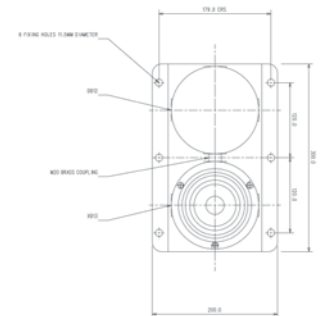

### Ordering Information — Standard product Specify options 1 – 3

Product	1. Voltage	2. Lens colour	3. Finish
DB12 / XB13	+ see above	+ Red Amber	+ Natural Red



## Speakers

Cooper MEDC's range of hazardous, heavy duty, industrial and commercial speakers are designed to meet the requirements for public address, voice alarm (evacuation) and background music. The speakers can generally operate as stand-alone units, or as part of 100 or 70 volt line systems.

Additionally a wide range of sound output levels (dB / Watts) are available. The speakers sound output in dB(A) is measured to European standards at 1 watt / 1 metre.



## DB4 | 8 - 25 Watt Speaker – Explosionproof & Weatherproof



Certification	<b>Ex</b> ATEX, UL, GOST 'R' & 'K', SAA, Inmetro
Flameproof	ATEX Ex II 2GD, EExd(e) IIC T4/T5
Area Classification	Zone 1, Zone 2 & non-Ex use.
Certified Ambient Temperature	-20°C to +70°C (standard) -55°C to +70°C (low temp unit)
Ingress Protection	IP66 & 67
Material	Corrosion-free GRP
Output	107 dBA at 1W at 1 metre 119 dBA at 25W at 1 metre
Entries	Up to 2 x 20mm
Weight	5.0kg
Tappings @ 25 watts	25, 12.5, 6, 4, 2, 1
Options	Power (8W, 15W, 20W, 25W), body colour, tag & duty labels, BS5839, part 8 compliance, certification, terminal chamber, transformer voltage

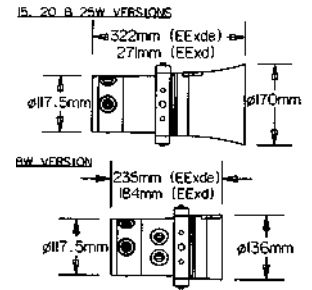

Standard models.  
Available ex-stock.

Certification	Power	Ordering Code
ATEX EX II 2GD	15 Watts	PX804215
ATEX EX II 2GD	25 Watts	PX804225

### Standard Product Configuration

Standard model has natural black finish, no labels, 2 x 20mm entries, fitted with one certified plug & 100V line transformer.

## DB10 | 8 & 15 Watt Speaker – Explosionproof & Weatherproof



15 Watt\*

\*8 Watt version has short flare.

Certification	<b>Ex</b> ATEX, GOST 'R' & 'K', CQST, Inmetro
Flameproof & Increased Safety	ATEX Ex II 2G, EExde IIB & H2 T4, T5 & T6
Area Classification	Zone 1, Zone 2 & non-Ex use.
Certified Ambient Temperature	-55°C to +70°C
Ingress Protection	IP66 & 67
Material	Corrosion-free GRP
Output	105 dBA at 1W 1 metre 115 dBA at 15W at 1 metre
Entries	Up to 2 x 20mm
Weight	3.2kg (model dependent)
Tappings @ 15 Watts	15, 7.5, 5, 4, 2, 0.8
Options	Body colour, tag & duty labels, transformer voltage

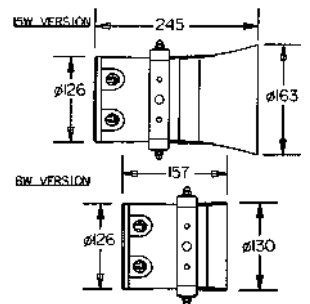

Standard models.  
Available ex-stock.

Certification	Power	Ordering Code
ATEX Ex II 2G	15 Watts	PX807915
ATEX Ex II 2G	8 Watts	PX807908

### Standard Product Configuration

Standard model has 100V line transformer, natural black GRP body, 2 x 20mm entries, fitted with one certified plug, integral E-chamber, earth continuity.

## DB14 | 15 Watt Speaker – Weatherproof & Heavy Duty

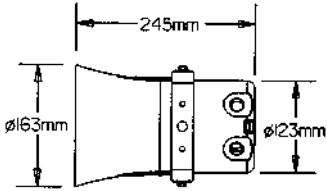

Area Classification	<b>Weatherproof.</b>
Ambient Operating Temperature	<b>-55°C to +70°C</b>
Ingress Protection	<b>IP66 &amp; 67</b>
Material	<b>Corrosion-free GRP</b>
Output	<b>107 dBA at 1W at 1 metre 117 dBA at 15W at 1 metre</b>
Entries	<b>2 x 20mm</b>
Weight	<b>2.6kg</b>
Tappings	<b>15, 7.5, 5, 4, 2, 0.8</b>
Options	<b>Painted grey, tag &amp; duty labels, transformer voltage, BS 5839, part 8 compliance, earth continuity</b>



Standard models.  
Available ex-stock.

**Ordering Code**  
PX808010

**Standard Product Configuration**  
Standard model has 100V line transformer, painted grey GRP body to, 2 x 20mm entries, no labels.

## Explosionproof & Weatherproof – 25 and 30 Watt Speaker | DB16

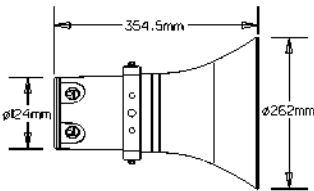

Certification	<b>ATEX, UL, GOST 'K', Inmetro</b>
Area Classification	<b>ATEX Ex II 2G, EExde IIB T3 ATEX Ex II 2GD, EExde IIC T110°C</b>
Certified Ambient Temperature	<b>Zone 1, Zone 2 &amp; non-Ex use.</b>
Ingress Protection	<b>-50°C to +65°C (25W) -50°C to +40°C (30W)</b>
Material	<b>IP66 &amp; 67</b>
Output	<b>Corrosion-free GRP</b>
See data sheet for additional output	<b>IIB version: 1W/1m is 110dBA 25W/1m is 121dBA 30W/1m is 122dBA</b>
Entries	<b>IIC version: 3dBA less than IIB versions</b>
Weight	<b>Up to 2 x 20mm or 2 x 25mm</b>
Tappings @ 30 Watts	<b>5.5kg</b>
Options	<b>30, 25, 12, 6, 4, 2</b>
	<b>Body colour, 30W or 25W, transformer, tag &amp; duty labels.</b>



## Explosionproof & Weatherproof – 8 & 4 Watt Speaker | DB20 & DB20C

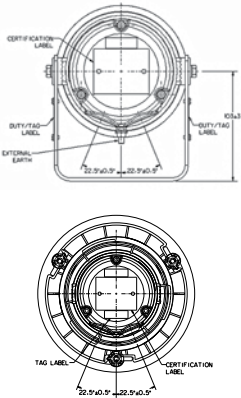

Certification	ATEX, IECEx, GOST 'R' and 'K', Inmetro
Flameproof and Increased Safety	ATEX Ex II 2G, Exde IIB T3/T4 ATEX Ex II 2GD Exde IIC T4/T5
Area Classification	Zone 1 & 2 (and Zone 21 & 22 : IIC version)
Certified Operating Temperature	-55°C to +70°C (DB20) -50°C to +70°C (DB20C)
Ingress Protection	IP66/67
Main body material	Corrosion-free GRP and ABS (DB20C)
Output IIC version	110 dB(A) (DB20) 100 dB (DB20C) at 1W at 1 metre 106 dB(A) at 4W at 1 metre 109 dB(A) at 8W at 1 metre
IIB version	3 dB(A) higher than IIC versions
Entries	2 x 20mm
Dimensions / Weight	L137 x Ø124mm / 1.5kg
Tappings @ 4 Watts	4, 2, 1, 0.75, 0.38, 0.2
Tappings @ 8 Watts	8, 4, 2, 1.5, 0.75, 0.4



Available in stirrup or ceiling mount

Standard models.  
Available ex-stock.

### Ordering Code

PX804301 8 watts  
PX804302 4 watts

PX804304 8 watts  
PX804305 4 watts

### Standard Product Configuration

Standard ATEX IIC models have 100V line transformer, natural black GRP body, 2 x 20mm entry, one certified plug, no label.

Standard ATEX IIB models have 100V line transformer, natural black GRP body, 2 x 20mm entry, one certified plug, no label.



## Detectors, Controls, Distribution

Here at Cooper MEDC we offer standard and bespoke control and distribution units for harsh and hazardous areas.

The control units are designed with convenient operation, safety and reliability in mind. As a leading manufacturer of hazardous area and explosion proof equipment, Cooper MEDC can provide hazardous and safe area control units in a range of dimensions to suit your required specification\*.

\*Manufacturer dependent.



## HD1 | Heat Detector – Explosionproof & Intrinsically Safe



EExd  
EExia/EExem

Certification	ATEX, GOST 'R' & 'K', CQST, Inmetro, Dual Listed AU
Flameproof	ATEX Ex II 2G, EExd IIB T6
Area Classification	Zone 0, Zone 1 and Zone 2 use.
Increased Safety	ATEX Ex II 2G, EExem II T6
Intrinsically Safe	ATEX Ex II 1G, EExia IIC T6
Certified Ambient Temperature	-20°C to +125°C EExd (T3) ATEX/GOST 'R' -20°C to +55°C EExd (T6)/EExem -55°C to +55°C EExia
Ingress Protection	IP66 & 67
Material	Marine Grade Alloy (EExd) Corrosion-free GRP (EExia/EExem)
Temperature Settings	140°F to 725°F (60°C to 385°C)
Entries	2 x 20mm
Weight	1.1-2.0kg (model dependent)
Options	Enclosures, guard, colour, tag and duty labels, temperature setting. Series and EOL resistors, blanking plugs.

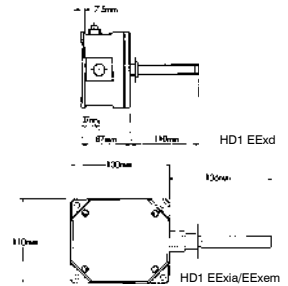

## JB10 & JB11 | GRP Junction Boxes – Explosionproof & Weatherproof



Certification	ATEX, UL
Increased Safety	ATEX Ex II 2G, EExe(m) II T3, T4, T5 & T6
Area Classification	Zone 1 & 2 use.
Certified Operating Temperature	-55°C to +55°C (model dependent)
Ingress Protection	IP66 & 67
Material	Corrosion-free GRP
Entries	Multiple entries per face *
Weight	1.1kg JB10 approx 1.8kg JB11 approx
Options	Body colour, tag label, terminals, external earth, gland continuity, LED, stainless steel fittings, side cable entries, high temp. version (up to +125°C)

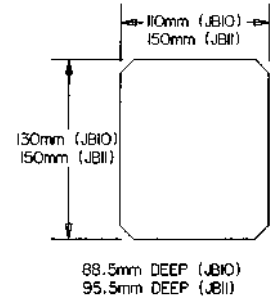

\* Refer to datasheet

Standard models.  
Available ex-stock.

Certification	Terminals	Ordering Code	Model
ATEX Ex II 2G	6 x SAK 2.5	PX810001	JB10

**Standard Product Configuration**  
Standard models have earth terminal, gland continuity,  
4 x M20 entries, 1 on each face, natural black finish.

## GHG 41181 | Control Units – Explosionproof & Weatherproof



\*Dependent on version

Certification	ATEX, UL
Increased Safety	ATEX Ex II 2GD, EExed IIC T6
Area Classification	Zones 1,2 and safe area.
Certified Ambient Temperature	-55°C to +50°C, Versions with switch -55°C to +45°C
Ingress Protection	IP65 & 66*
Material	Impact Resistant Thermo Plastic
Entries	1x M20 Bottom entry as standard
Weight	Approx. 0.5kg (model dependant)
Options	Pushbuttons, emergency stop, rotary switches & block, potentiometer, lamps, key switch, gold contact block.

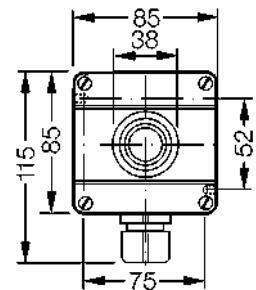

Standard models.  
Available ex-stock.

Certification	Ordering Code
ATEX Ex II 2GD	PX809102 - Em Stop M/H* PX809101 - P/B*

\* Refer to datasheet



## Explosionproof & Weatherproof – Control Units | GHG 41182

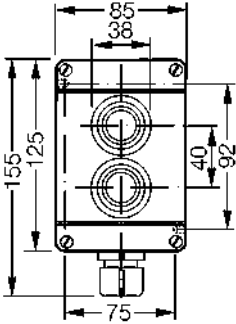

Certification	Ⓔ ATEX, UL
Increased Safety	ATEX Ex II 2GD, EExed IIC T6
Area Classification	Zones 1,2 and safe area.
Certified Ambient Temperature	-55°C to +50°C, Versions with switch -55°C to +45°C
Ingress Protection	IP65 & 66*
Material	Impact Resistant Thermo Plastic
Entries	1x M20 Bottom entry as standard
Weight	Approx. 0.5kg (model dependant)
Options	Pushbuttons, emergency stop, contact block, padlockable, rotary switches & block, potentiometer, lamps, gold contact block.



\*Dependent on version

Standard models.  
Available ex-stock.

**Certification**  
ATEX Ex II 2GD

**Ordering Code**  
PX809201 - Start Stop\*  
PX809202 - Start Em-Stop\*

\* Refer to datasheet

## Explosionproof & Weatherproof – Control Units | GHG 41183

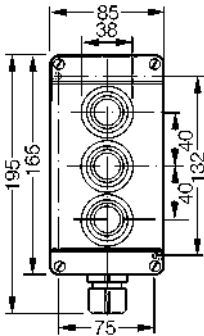

Certification	Ⓔ ATEX, UL
Increased Safety	ATEX Ex II 2GD, EExed IIC T6
Area Classification	Zones 1,2 and safe area.
Certified Ambient Temperature	-55°C to +50°C, Versions with switch -55°C to +45°C
Ingress Protection	IP65 & 66*
Material	Impact Resistant Thermo Plastic
Entries	1x M20 Bottom entry as standard
Weight	Approx. 1.3kg (model dependant)
Options	Pushbuttons, emergency stop, contact block, padlockable, rotary switches & block, potentiometer, lamps, gold contact block.



\*Dependent on version

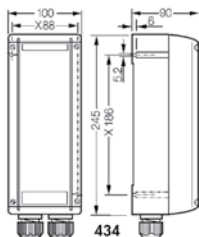

## EExed & Weatherproof | 432 434 Range

Certification	Ⓔ Ex, ATEX, UL
Area Classification	Zones 1,2 and safe area
Certified Ambient Temperature	-55°C to +50°C, Versions with switch -55°C to +45°C
Ingress Protection	IP65/66*
Material	Impact Resistant Thermo Plastic
Entries	2x M20 Bottom entry as standard
Weight	0.8kg to 1.6kg
Options	Pushbuttons, emergency stop, contact block, rotary switches & block, potentiometer, lamps, gold contact block.

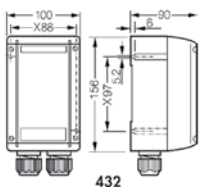

\*Dependent on version

## GHG 74 & 44 Range | Terminal Boxes & Control Units – *Explosionproof & Weatherproof*



\*Dependent on version

A range of GRP or 316 Stainless Steel Terminal Boxes and Control Units. The Control Units can be fitted with a variety of lamps, switches, pushbuttons and other accessories.

<b>Certification</b>	⊕ ATEX, UL			
<b>Increased Safety</b>	ATEX Ex II 2GD, EExe II T4/T6*			
<b>Ingress Protection</b>	IP65/66*			
<b>Area Classification</b>	Model dependant - refer to datasheet			
<b>Material</b>	Corrosion-free GRP or 316 Stainless Steel			
<b>Dimensions (mm):</b>				
<b>Box Type</b>	<b>Box Type</b>	<b>Width x</b>	<b>Height x</b>	<b>Depth*</b>
444 23	744 01	271	134	136
448 23	745 02	271	271	136
449 23	746 02	544	271	136
471 23	749 04	817	271	136
444 33	744 21	175	312.5	151
448 33	745 22	312.5	312.5	151
449 33	146 23	312.5	312.5	151
447 33	749 24	941.5	312.5	151

## GP1, 2, 3 & 4 , G2, JL Range | Control Units & Motor Starters – *Explosionproof & Weatherproof*



A range of custom built control and motor starter units which can be used individually or combined to provide hazardous area systems for indoor or outdoor use.

<b>Certification</b>	⊕ ATEX		
<b>Flameproof</b>	ATEX Ex II 2G, EExd		
<b>Ingress Protection</b>	IP65 & 66		
<b>Area Classification</b>	Model dependant - refer to datasheet		
<b>Material</b>	Cast iron, Stainless Steel or Alloy *		
<b>Dimensions (mm):</b>			
	<b>Width x</b>	<b>Height x</b>	<b>Depth</b>
GP1/GP1S	580	480	240
GP2/GP2S	480	275	243
GP3/GP3S	580	480	365
JL4/2/JL4/2S	305	265	150
JL4/3/JL4/3S	305	265	237
G2/G2S	156	257	175

\*Model dependant

## Distribution Panels & Boards | – *Explosionproof & Weatherproof*



A range of custom built distribution systems utilising Cooper MEDC's expertise in hazardous area applications to ensure a safe and reliable solution to customer specifications.

<b>Certification</b>	⊕ ATEX		
<b>Flameproof</b>	ATEX Ex II 2G, EExd IIB		
<b>Ingress Protection</b>	IP66		
<b>Area Classification</b>	Model dependant - refer to datasheet		
<b>Material</b>	Cast iron, Stainless Steel or Alloy. *		

\*Model dependant



## Heavy Duty Industrial & Marine

Cooper MEDC offer products suitable for Heavy Duty Industrial and Marine environments.

The Cooper MEDC range includes sounders, beacons, combination units in heavy duty designs with high ingress protection ratings.

Products conform to IP 66 & 67 ratings, as well as a variety of other globally recognised certifications.



## BG3W | Break Glass Call Point – Weatherproof & Heavy Duty



Area Classification	Model dependant - refer to datasheet
Operating Temperature	-55°C to +55°C
Ingress Protection	IP66 & 67
Material	Corrosion-free GRP
Entries	2 x 20mm
Weight	0.5kg
Options	Body colour, LED, lift flap, series & EOL resistors, tag & duty labels.

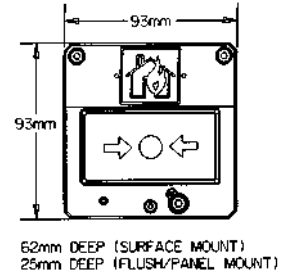

Standard models.  
Available ex-stock.

**Ordering Code**  
PX800006

### Standard Product Configuration

Standard models are surface mount version, have 2 x 20mm bottom entries, natural red GRP, single switch glass label 'Fire Break Glass Press Here', duty label 'Burning House'

## XB13 | 10 Joule Flashing Xenon – Weatherproof & Heavy Duty



Area Classification	Weatherproof.
Operating Temperature	-55°C to +70°C
Ingress Protection	IP66 & 67
Material	Corrosion-free GRP body, Polycarbonate lens
Entries	Up to 3 x 20mm via knockouts
Weight	1.1kg
Options	Body & lens colour, tag & duty labels, lens guard, telephone & relay initiate, single & dual flash mode, voltages 12-24V d.c., 115-230V a.c.

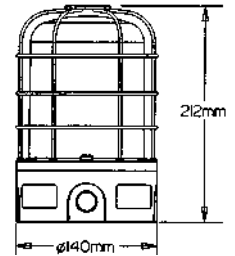

Standard models.  
Available ex-stock.

Voltage	Lens Colour	Ordering Code
24V d.c.	Red	PX813101
24V d.c.	Amber	PX813102
230V a.c.	Red	PX813103

### Standard Product Configuration

Standard models are in painted red body colour, no tag or duty labels, no lens guard, 3 x 20mm entries via knockouts, 60 flashes per minute (single flash mode), dual & single flash modes.

## DB12 | 110dB(A) Sounder – Weatherproof & Heavy Duty



Area Classification	Weatherproof.
Operating Temperature	-55°C to +70°C
Ingress Protection	IP66 & 67
Material	Corrosion-free GRP
Entries	Up to 3 x 20mm via knockouts
Weight	1kg d.c 1.2kg a.c.
No. of Tones	27
Options	Body colour, tag & duty labels, voltages 12V & 24V d.c.

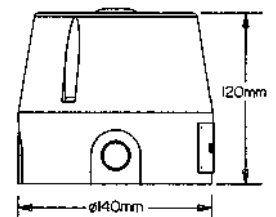

Standard models.  
Available ex-stock.

Voltage	Alarm Type	Ordering Code
24V d.c.	Two Stage	PX808001
115/230V a.c.	Single Stage	PX808003

### Standard Product Configuration

Standard model has 27 tones, painted red body colour, no tag or duty labels, 3 x 20mm entries via knockouts.

## Weatherproof & Heavy Duty – 117dB(A) Sounder | **DB15**

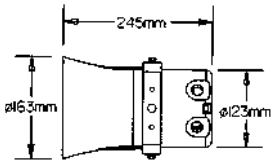

Area Classification	<b>Weatherproof.</b>
Operating Temperature	<b>-55°C to +70°C</b>
Ingress Protection	<b>IP66 &amp; 67</b>
Material	<b>Corrosion-free GRP</b>
Entries	<b>2 x 20mm</b>
Weight	<b>2.6kg</b>
No. of Tones	<b>27 + 5 programmable</b>
Options	<b>Painted grey, tag &amp; duty labels, two stage alarm (DB15P) version, earth continuity, EOL resistor, voltages 12-48V d.c., *110-254V a.c.</b>



\*Not available in a.c. version for DB15P.

Standard models.  
Available ex-stock.

Voltage	Body Colour	Alarm Type	Ordering Code
24-48V d.c.	Grey	Two stage	PX808110
24-48V d.c.	Red	Two stage	PX808115
240V a.c.	Grey	Single stage	PX808120
240V a.c.	Red	Single stage	PX808125

**Standard Product Configuration**

Standard model has 27 tones, 2 x 20mm entries.

## Weatherproof & Heavy Duty – 15 Watt Speaker | **DB14**

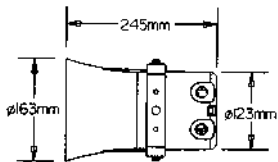

Area Classification	<b>Weatherproof.</b>
Ambient Operating Temperature	<b>-55°C to +70°C</b>
Ingress Protection	<b>IP66 &amp; 67</b>
Material	<b>Corrosion-free GRP</b>
Output	<b>107 dBA at 1W at 1 metre</b> <b>117 dBA at 15W at 1 metre</b>
Entries	<b>2 x 20mm</b>
Weight	<b>2.6kg</b>
Tappings	<b>15, 7.5, 5, 4, 2, 0.8</b>
Options	<b>Painted grey, tag &amp; duty labels, transformer voltage, BS 5839, part 8 compliance, earth continuity</b>



Standard models.  
Available ex-stock.

**Ordering Code**  
PX808010

**Standard Product Configuration**

Standard model has 100V line transformer, painted grey GRP body to RAL 7035, 2 x 20mm entries, no labels.



© BP p.l.c

## North American Certified Products

This section includes products which are internationally approved within North America.



## Exd, Weatherproof — Status Lights | **SL15 UL**

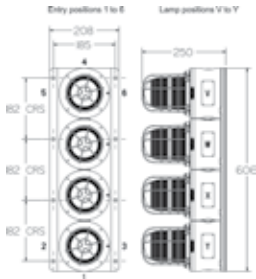

Certification	<b>UL, ATEX, and IEC Ex Approved</b>
Area Classification	<b>Model dependant - refer to datasheet</b>
Certified Ambient Temperature	<b>-55°C to +70°C</b>
Ingress Protection	<b>IP66 &amp; 67</b>
Material	<b>Corrosion-free GRP</b>
Entries	<b>Up to 2 x 1/2" or 2 x 3/4" entries. ATEX has M20 or M25.</b>
No. of Ways	<b>Up to 4</b>
Options	<b>Various flash rates available for xenon units. Various lens colours. Optional cast or wire lens guard.</b>



UL Version

## Explosionproof & Weatherproof — Push Button Fire Alarm Call Point | **SM87PB UL**

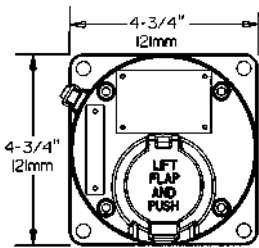

5-3/16" / 132mm DEEP

North American Certifications	<b>UL, ULC, CSA, Class I, Div 1, Groups C &amp; D, Class I, Zone 1</b>
Area Classification	<b>Model dependant - refer to datasheet</b>
Certified Ambient Temperature	<b>-67°F to +158°F</b> <b>-55°C to +70°C</b>
Ingress Protection	<b>NEMA 4x &amp; 6</b> <b>IP66 &amp; 67</b>
Material	<b>Marine Grade Alloy</b>
Entries	<b>Up to 4 x 1/2" or 3/4" NPT</b>
Weight	<b>5.5lb/2.5kg</b>
Options	<b>Body color, tag &amp; duty labels, LED, series or EOL resistor, diode, addressable module, certification</b>



## Hazardous Locations — Break Glass Fire Alarm Call Point | **BG UL**

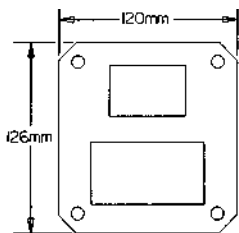

75mm DEEP

North American Certifications	<b>UL, Class I, Div 2, Groups A, B, C &amp; D, Class I, Zone 2</b>
Area Classification	<b>Model dependant - refer to datasheet</b>
Certified Ambient Temperature	<b>-13°F to +131°F</b> <b>-25°C to +55°C</b>
Ingress Protection	<b>NEMA 4x &amp; 6</b> <b>IP66 &amp; 67</b>
Material	<b>Corrosion-free GRP</b>
Entries	<b>Up to 4 x 1/2" NPT</b>
Weight	<b>2.6lb/1.2kg</b>
Options	<b>Body color, tag &amp; duty labels, LED, liftflap, series or EOL resistor, plastic element, single or double pole switch, certification</b>



Standard models stocked in U.S.  
- contact the U.S. sales office

Standard models.  
Available ex-stock.

Ordering Code  
PX869101

Product description  
BGUL4C6C1DSN6R

## Hazardous Locations — Push Button Fire Alarm Call Point | **PB UL**

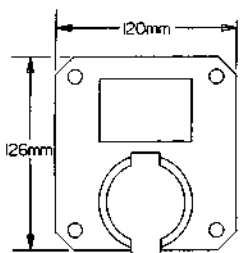

114mm DEEP

North American Certifications	<b>UL, CSA, Class I, Div 2, Groups A, B, C &amp; D, Class I, Zone 2</b>
Area Classification	<b>Model dependant - refer to datasheet</b>
Certified Ambient Temperature	<b>-13°F to +131°F</b> <b>-25°C to +55°C</b>
Ingress Protection	<b>NEMA 4x &amp; 6</b> <b>IP66 &amp; 67</b>
Material	<b>Corrosion-free GRP</b>
Entries	<b>Up to 4 x 1/2" NPT</b>
Weight	<b>2.6lb/1.2kg</b>
Options	<b>Body color, tag &amp; duty labels, LED, series or EOL resistor, single or double pole switch, certification</b>



Standard models stocked in U.S.  
- contact the U.S. sales office

Standard models.  
Available ex-stock.

Ordering Code  
PX869105

Product description  
PBUL4C6C0DSN7R

## SM87SL UL | Xenon, Filament & Fluorescent Status Lights – *Explosionproof & Weatherproof*



North American Certifications	<b>UL, CSA, Class I, Div 1, Groups C &amp; D, Class I, Zone 1, AExd IIB T4 &amp; T6</b>
Area Classification	<b>Model dependant - refer to datasheet</b>
Certified Ambient Temperature	<b>-13°F to +131°F -25°C to +55°C*</b>
Ingress Protection	<b>NEMA 4x &amp; 6 IP66 &amp; 67</b>
Material	<b>Alloy</b>
Entries	<b>Up to 3 x 1/2" or 3/4" NPT</b>
No. of Lights	<b>2,3, 4 or 5</b>
Options	<b>Body &amp; lens colour, tag &amp; duty labels, certification, voltages 24-48V d.c., 110-254V a.c.</b>

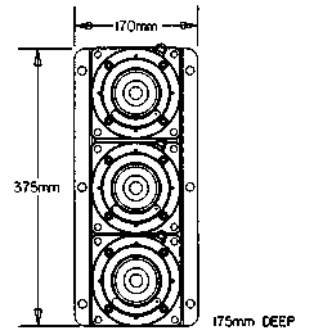

\*Model dependant, refer to data sheet.

## XB11SL UL | Xenon & Filament Status Lights – *Hazardous Locations*



North American Certifications	<b>UL, Class I, Div 2, Groups C &amp; D, Class 1, Zones 1 &amp; 2, AExd IIB T4</b>
Area Classification	<b>Model dependant - refer to datasheet</b>
Certified Ambient Temperature	<b>-67°F to +158°F -55°C to +70°C</b>
Ingress Protection	<b>NEMA 4x &amp; 6 IP66 &amp; 67</b>
Material	<b>Corrosion-free GRP</b>
Entries	<b>1 x 1/2" NPT</b>
No. of Lights	<b>2,3,4, or 5</b>
Options	<b>Body &amp; lens color, tag &amp; duty labels.</b>

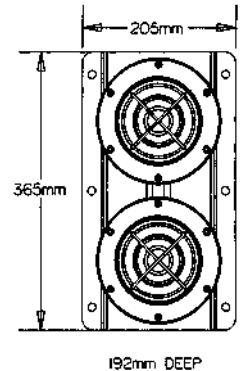

## XB12SL UL | Xenon & Filament Status Lights – *Hazardous Locations*



North American Certifications	<b>UL, Class I, Div 2, Groups C &amp; D, Class I, Zones 1 &amp; 2, AExd IIB T4 &amp; T5</b>
Area Classification	<b>Model dependant - refer to datasheet</b>
Certified Ambient Temperature	<b>-67°F to +158°F -55°C to +70°C</b>
Ingress Protection	<b>NEMA 4x &amp; 6 IP66 &amp; 67</b>
Material	<b>Corrosion-free GRP</b>
Entries	<b>1 x 1/2" NPT</b>
No. of Lights	<b>2, 3, 4 or 5</b>
Options	<b>Body &amp; lens color, tag &amp; duty labels, certification, voltages 24V d.c., 110-254V a.c.</b>

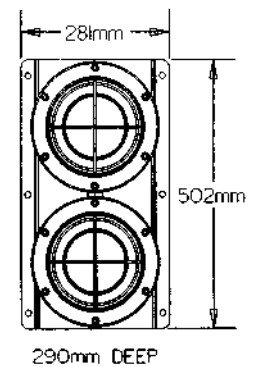



## Explosionproof & Weatherproof – 5 Joule Xenon Strobe | **SM87 HXB UL**

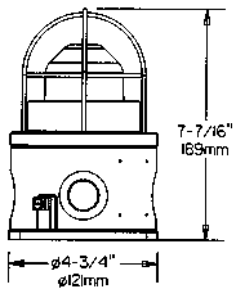

North American Certifications	UL, CSA, Class I, Div 1, Groups C & D, Class I, Zone 1, AExd IIB
Area Classification	Model dependant - refer to datasheet
Certified Ambient Temperature	-67°F to +158°F -55°C to +70°C
Ingress Protection	NEMA 4x & 6 IP66 & 67
Material	Alloy
Entries	Up to 4 x 1/2" or 3/4" NPT
Weight	4.4lb/2.0kg approx
Options	Body & lens color, tag & duty labels, certification, lens guard, flash rate, voltages 24-48V d.c., 110-254V a.c., high temp version up to 185°F/85°C



Standard model stocked in U.S. - contact the U.S. sales office

## Hazardous Locations – 5 Joule Xenon Strobe | **XB11 UL**

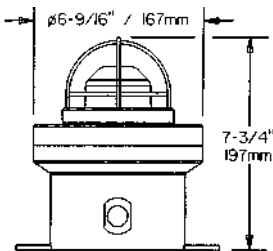

North American Certifications	UL, Class I, Div 2, Groups C & D, Class I, Zones 1 & 2, AExd IIB T5
Area Classification	Model dependant - refer to datasheet
Certified Ambient Temperature	-67°F to +158°F -55°C to +70°C
Ingress Protection	NEMA 4x & 6 IP66 & 67
Material	Corrosion-free GRP
Entries	2 x 1/2" NPT
Weight	5 1/2 lb 2.5kg
Options	Body & lens color, tag & duty labels, lens guard, flash rate, certification, mounting method. voltages 24V d.c., 110-254V a.c.,



Standard model stocked in U.S. - contact the U.S. sales office

Standard models. Available ex-stock.	<b>Ordering Code</b> PX869174	<b>Product description</b> XB11UL02406CNBNNR
--------------------------------------	----------------------------------	---

## Hazardous & Ordinary Locations – 10 Joule Flashing Xenon | **XB16 UL**

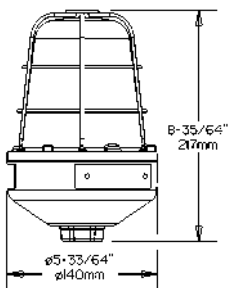

\* UL1971 version only available with clear lens option

North American Certifications	UL 1971 compliant*, Class I, Div 2, Groups A-D Class II, Div 2, Groups F & G
Area Classification	Model dependant - refer to datasheet
Certified Ambient Temperature	-67°F to +158°F -55°C to +70°C
Ingress Protection	NEMA 4x & 6 IP66 & 67
Material	Corrosion-free GRP
Entries	Standard 1 x 3/4" NPT
Weight	2.2lb/1kg
Options	Body & lens color, lens guard, tag & duty labels, initiation options, flash rate, voltages 24-48V d.c., 110-254V a.c.



Standard model stocked in U.S. - contact the U.S. sales office

Standard models. Available ex-stock.	<b>Ordering Code</b> PX869407	<b>Product description</b> XB16UL12060RYNN
--------------------------------------	----------------------------------	---

## XB15 UL | 15 Joule Flashing Xenon – Hazardous & Ordinary Locations



North American Certifications	UL, ULC, Class I, Div 2, Groups A, B, C, D Class II, Div 2, Groups F&G, Class I, Zone I, AExd IIC T4/T5/T6
Area Classification	Model dependant - refer to datasheet
Certified Ambient Temperature	-67°F to +158°F -55°C to +70°C
Ingress Protection	NEMA 4x & 6 IP66 & 67
Material	Corrosion-free GRP
Entries	Up to 3 x 1/2" NPT or 3 x 3/4" NPT Pipe mount = 1 x 1/2" or 1 x 3/4" NPT
Weight	5 3/4lb/2.6kg Pipe Mount 6 1/2lb/3.0kg Direct Mount
Options	Body & lens color, relay initiate, flash rate, voltages 24-48V d.c., 110-254V a.c.

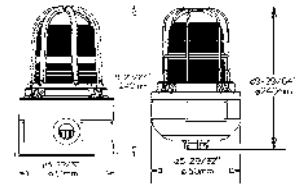

Direct Mount Pipe Mount

Standard model stocked in U.S. - contact the U.S. sales office

Standard models. Available ex-stock.	Ordering Code PX869402	Product description XB15UL12006RWPNN
---	---------------------------	---

## XB12 UL | 21 Joule Xenon Strobe – Hazardous Locations



North American Certifications	UL, Class I, Div 2, Groups C & D, Class I, Zones 1 & 2, AExd IIB T4 & T5
Area Classification	Model dependant - refer to datasheet
Certified Ambient Temperature	-67°F to +158°F -55°C to +70°C
Ingress Protection	NEMA 4x & 6 IP66 & 67
Material	Corrosion-free GRP
Entries	Up to 2 x 1/2" NPT
Weight	15.5lb/7.0kg
Options	Body & lens color, tag & duty labels, lens guard, flash rate, certification, mounting method voltages 24V d.c., 110-254V a.c.

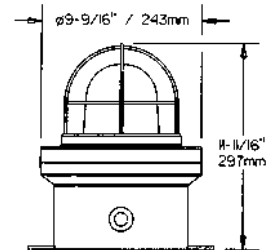

## XB4 UL | 21 Joule Xenon Strobe – Explosionproof & Weatherproof



North American Certifications	UL, Class I, Div 1, Groups C & D, Class I, Zone 1, AExd IIB T4
Area Classification	Model dependant - refer to datasheet
Certified Temperature	-67°F to +158°F -55°C to +70°C
Ingress Protection	NEMA 4x & 6 IP66 & 67
Material	Alloy or Stainless Steel
Entries	Up to 3 x 1/2" or 3/4" NPT
Weight	14.5lb/6.6kg LM Alloy
Options	Body & lens color, tag & duty labels, lens guard, flash rate, certification, voltages 24V d.c., 110V & 240V a.c.

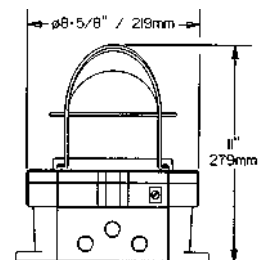

*Explosionproof & Weatherproof* – LU3 UL 10 Watt Steady Filament Light | **SM87 LU3 UL**

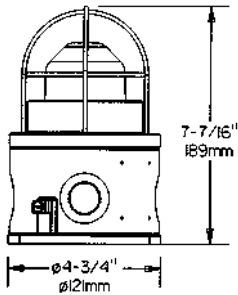

North American Certifications	UL, CSA, Class I, Div 1, Groups C & D, Class I, Zone 1, AExd IIB
Area Classification	Model dependant - refer to datasheet
Certified Temperature	-67°F to +131°F -55°C to +55°C
Ingress Protection	NEMA 4x & 6 IP66 & 67
Material	Alloy
Entries	2 x 1/2" or 3/4" NPT
Weight	4.4lb/2.0kg
Options	Body & lens colour, tag & duty labels, lens guard, certification, voltages 12, 24, 48V d.c., 110V-254V a.c.



Standard model stocked in U.S. - contact the U.S. sales office

*Hazardous Locations* – 10 Watt Steady Filament Light | **FB11 UL**

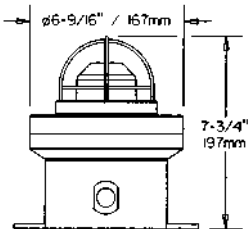

\*Model dependant

North American Certifications	UL, Class I, Div 2, Groups C & D, Class I, Zone 1, AExd IIB T4/T5
Area Classification	Model dependant - refer to datasheet
Certified Temperature	*-67°F to +131°F -55°C to +55°C
Ingress Protection	NEMA 4x & 6 IP66 & 67
Material	Corrosion-free GRP
Entries	Up to 2 x 1/2" NPT
Weight	6.2lb/2.8kg
Options	Body & lens color, tag & duty labels, lens guard, mounting method, certification, voltage 24, 48V d.c., 110 – 120V a.c.



*Hazardous Locations* – 60/100 Watt Steady Filament Light | **FB12 UL**

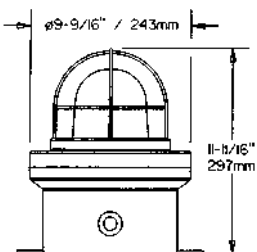

\*Model dependant

North American Certifications	UL, Class I, Div 2, Groups C & D, Class I, Zone 1, AExd IIB T4/T5
Area Classification	Model dependant - refer to datasheet
Certified Temperature	*-67°F to +131°F -55°C to +55°C
Ingress Protection	NEMA 4x & 6 IP66 & 67
Material	Corrosion-free GRP
Entries	Up to 2 x 1/2" NPT
Weight	16.7lb/7.6kg
Options	Body & lens color, tag & duty labels, lens guard, mounting method, certification, voltage 120V a.c.



## FB15 UL | 60W Steady Filament Light – Hazardous & Ordinary Locations



North American Certifications	UL, Class I, Div 2, Groups A,B,C, & D Class I, Zone 1, AExd IIC T3/T4
Area Classification	Model dependant - refer to datasheet
Certified Temperature	*-67°F to +158°F -55°C to +70°C
Ingress Protection	NEMA 4x & 6 IP66 & 67
Material	Corrosion-free GRP / Metal Cover for Pipe Mounted Unit
Entries	Up to 3 x 1/2" NPT or 3 x 3/4" NPT
Weight	5 3/4lb/2.6kg Pipe Mount 6 1/2lb/3.0kg Direct Mount
Options	Body & lens color, lens guard, tag & duty labels, lamp wattage, unit fixing, mounting method, voltages 24-48V d.c., 110-254V a.c.

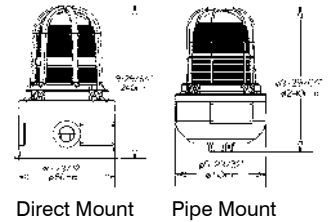

\*Model dependant

## FB4 UL | 60 Watt Steady Filament Light – Explosionproof & Weatherproof



North American Certifications	UL, ATEX, Class I, Div 1, Groups C & D, Class I, Zone 1, AExd IIB T3 & T4
Area Classification	Model dependant - refer to datasheet
Certified Temperature	-67°F to +131°F -55°C to +55°C
Ingress Protection	NEMA 4x & 6 IP66 & 67
Material	Alloy
Entries	Up to 3 x 1/2" or 2 x 3/4" NPT
Weight	*13lb/6.4kg
Options	Body & lens color, tag & duty labels, lens guard, relay initiate, certification, voltage 24V d.c., 110V a.c.

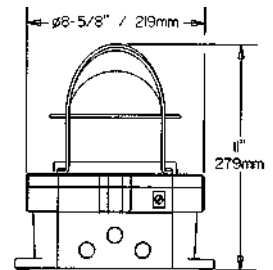

\*Model dependant

## SM87 LU1 UL | 10 Watt Steady Fluorescent Light – Explosionproof & Weatherproof



North American Certifications	UL, CSA, Class I, Div 1, Groups C & D, Class I, Zone 1, AExd IIB
Area Classification	Model dependant - refer to datasheet
Certified Temperature	-67°F to +131°F -55°C to +55°C
Ingress Protection	NEMA 4x & 6 IP66 & 67
Material	Alloy
Entries	2 x 1/2" or 3/4" NPT
Weight	4.4lb/2.0kg
Options	Body & lens colour, tag & duty labels, lens guard, certification, voltages 24-48V d.c. 220V-254V a.c.

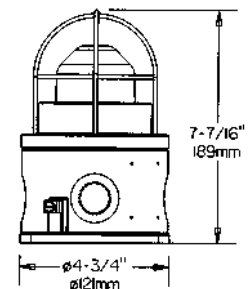

*Explosionproof & Weatherproof – 13-39 Watt Steady Fluorescent Light | FL4 UL*

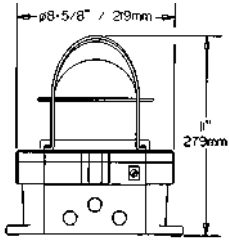

\*Model dependant

North American Certifications	<b>UL, Class I, Div 1, Groups C &amp; D, Class I, Zone 1, AExd IIC T5</b>
Area Classification	<b>Model dependant - refer to datasheet</b>
Certified Temperature	<b>-4°F to +131°F -20°C to +55°C</b>
Ingress Protection	<b>NEMA 4x &amp; 6 IP66 &amp; 67</b>
Material	<b>Alloy</b>
Entries	<b>Up to 3 x 1/2" NPT or 3 x 3/4" NPT</b>
Weight	<b>*14.5lb/6.6kg</b>
Options	<b>Body &amp; lens color, tag &amp; duty labels, lens guard, relay initiate, certification, voltages 24V d.c., 110V, 240V a.c.</b>



*Intrinsically Safe – FM Up to 93dB(A) @ 10ft Horn | DB5 FM UL*

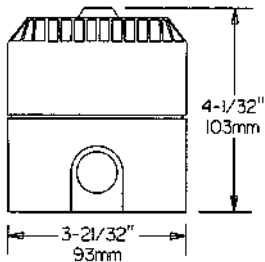

North American Certifications	<b>UL, FM, CSA, Class I, Div 1 &amp; 2, Groups A,B,C &amp; D</b>
Area Classification	<b>Model dependant - refer to datasheet</b>
Certified Temperature	<b>-4°F to +131°F -20°C to +55°C</b>
Ingress Protection	<b>NEMA 4 IP65</b>
Material	<b>Corrosion-free ABS</b>
Entries	<b>Up to 2 x 13/16" via knockouts</b>
Weight	<b>0.7lb/0.3kg</b>
No. of Tones	<b>26</b>
Options	<b>Body color, label, certification, voltages 12V-24V d.c.</b>



Standard models stocked in U.S. – contact the U.S. sales office.

*Explosionproof & Weatherproof – 103dB(A) @ 10ft Horn | DB1HP UL*

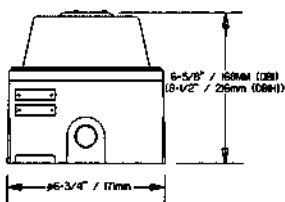

North American Certifications	<b>UL, Class I, Div 1, Groups C &amp; D, Class I, Zone 1</b>
Area Classification	<b>Model dependant - refer to datasheet</b>
Certified Temperature	<b>-13°F to +158°F -25°C to +70°C</b>
Ingress Protection	<b>NEMA 4x IP66</b>
Material	<b>Alloy</b>
Entries	<b>Up to 3 x 1/2" or 3/4" NPT</b>
Weight	<b>7.7lb/3.5kg (model dependant)</b>
No. of Tones	<b>27 + 5 Programmable</b>
Options	<b>Body color, tag &amp; duty labels, certification, voltages 12,24,48V d.c., 110V a.c.</b>



Standard models stocked in U.S. – contact the U.S. sales office.

## DB3 UL | 115dB(A) @ 1m Horn – Hazardous Locations



North American Certifications	UL, ULC, Class I, Div 2, Groups A,B,C & D Class II, Div 2, Groups F & G Class I, Zones 1 & 2, AExd IIC T4
Area Classification	Model dependant - refer to datasheet
Certified Temperature	-67°F to +158°F -55°C to +70°C
Ingress Protection	NEMA 4x & 6 IP65 & 67
Material	Corrosion-free GRP
Entries	Up to 2 x 1/2" NPT
Weight	11lb/5.0kg
No. of Tones	27 + 5 Programmable
Options	Body color, tag & duty labels, end of line resistor, certification, voltages 12-48V d.c., 110V-254V a.c.

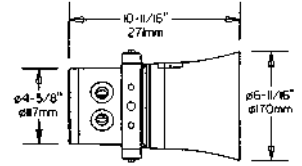

Standard model stocked in U.S. – contact the U.S. sales office.

Standard models. Available ex-stock.	Ordering Code PX869131	Product description DB3UL048N2CNRZ
---	---------------------------	---------------------------------------

## DB4 UL | 8-25 Watt Speaker – Hazardous Locations



North American Certifications	UL, Class I, Div 2, Groups A,B,C & D, Class I, Zone 1, AExd IIC T4
Area Classification	Model dependant - refer to datasheet
Certified Temperature	-67°F to +158°F -55°C to +70°C
Ingress Protection	NEMA 4x & 6 IP66 & 67
Material	Corrosion-free GRP
Entries	Up to 2 x 1/2" NPT
Weight	11lb/5.0kg
Output	97 dBA at 1W at 10 feet 109 dBA at 25W at 10 feet
Options	Body color, tag & duty labels, transformer, certification, power 25W, 15W, 8W

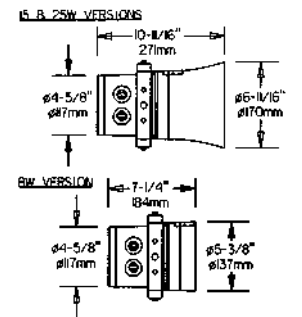

## DB16 UL | 30 Watt Speaker – Hazardous Locations



North American Certifications	UL, Class I, Div 2, Groups C & D/A-D Class I, Zone 1, AExde IIB T3/IIC T110°C
Area Classification	Model dependant - refer to datasheet
Certified Temperature	-61°F to +90°F -50°C to + 40°C
Ingress Protection	NEMA 4x & 6 IP66 & 67
Material	Corrosion-free GRP
*Output	Groups C & D: 100dBA at 1Watt at 10 feet 112dBA at 30 Watts at 10 feet Groups A-D: 3dBA less than C & D versions
Entries	Up to 2 x 1/2" NPT or 2 x 3/4" NPT
Weight	12.1lb/5.5kg
Tappings @ 30 Watts	30, 25, 12, 6, 4, 2
Options	Body color, transformer, tag & duty labels.

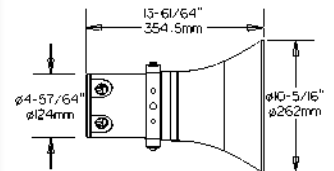

\*See data sheet for additional output.

## Hazardous Locations – Control Units | GHG 41181 UL

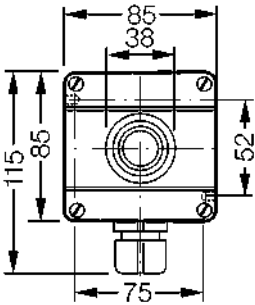

North American Certifications	UL, Class I, Div 2, Groups A,B,C & D Class I, Zone 1, AExde IIB+H2 T6 Class II, Div 1, Groups E,F&G(cUL)
Area Classification	Model dependant - refer to datasheet
Certified Temperature	-4°F to + 104°F -20°C to +40°C
Ingress Protection	NEMA 4x & 6, IP65 & 66 Impact Resistant Thermo Plastic
Material	1 x 1/2" NPT as standard
Entries	0.5kg - 1.3kg
Weight	Pushbuttons, emergency stop, padlockable, contact
Options	block, rotary switches & block, potentiometer, lamps



## Hazardous Locations – Control Units | GHG 41182 UL

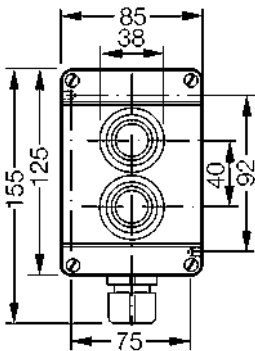

North American Certifications	UL, $\text{Ex}$ ATEX, Class I, Div 2, Groups A,B,C & D Class I, Zone 1, AExde IIB+H2 T6 Class II, Div 1, Groups E,F&G(cUL)
Area Classification	Model dependant - refer to datasheet
Certified Temperature	-4°F to + 104°F -20°C to +40°C
Ingress Protection	NEMA 4x & 6, IP65 & 66 Impact Resistant Thermo Plastic
Material	1 x 1/2" NPT as standard
Entries	0.5kg - 1.3kg
Weight	Pushbuttons, emergency stop, padlockable, contact
Options	block, rotary switches & block, potentiometer, lamps



## Hazardous Locations – Control Units | GHG 41183 UL

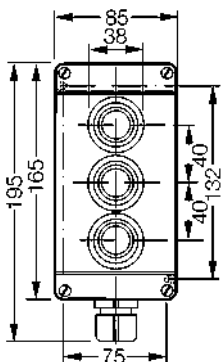

North American Certifications	UL, Class I, Div 2, Groups A,B,C & D Class I, Zone 1, AExde IIB+H2 T6 Class II, Div 1, Groups E,F&G(cUL)
Area Classification	Model dependant - refer to datasheet
Certified Temperature	-4°F to + 104°F -20°C to +40°C
Ingress Protection	NEMA 4x & 6, IP65 & 66*
Material	Impact Resistant Thermo Plastic
Entries	1 x 1/2" NPT as standard
Weight	0.5kg - 1.3kg
Options	Pushbuttons, emergency stop, padlockable, contact block, rotary switches & block, potentiometer, lamps



\*Model dependent



## 432 434 Range | EExed & Weatherproof

North American Certification	<b>Ex, ATEX, UL</b>
Area Classification	<b>Class I, Zone 1, AExde IIB+H2 T6 Class II, Div 1, Groups E,F&amp;G(cUL)</b>
Certified Ambient Temperature	<b>-4°F to + 104°F -20°C to +40°C</b>
Ingress Protection	<b>NEMA 4x &amp; 6, IP65 &amp; 66*</b>
Material	<b>Impact Resistant Thermo Plastic</b>
Entries	<b>2 x 1/2" NPT as standard</b>
Weight	<b>1.75lbs-3.5lbs / 0.8kg-1.6kg</b>
Options	<b>Pushbuttons, emergency stop, padlockable, contact block, rotary switches &amp; block, potentiometer, lamps.</b>

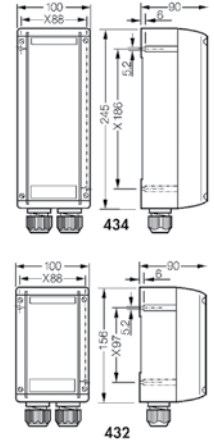

\*Model dependant

## JB10 & JB11 UL | GRP Junction Boxes – Explosionproof & Weatherproof



North American Certifications	<b>UL, Class I, Div 2, Groups A,B,C &amp; D Class I, Zone 1, AExe IIC T4 &amp; T5</b>
Area Classification	<b>Model dependant - refer to datasheet</b>
Certified Temperature	<b>-67°F to +131°F -55°C to +55°C</b>
Ingress Protection	<b>NEMA 4x &amp; 6, IP66 &amp; 67</b>
Material	<b>Corrosion-free GRP</b>
Entries	<b>Up to 8 entries (model dependant)</b>
Weight	<b>2.4-4lbs/1.1kg-1.8kg</b>
Options	<b>Body color, tag label, gland continuity, extra internal earth, terminal type</b>

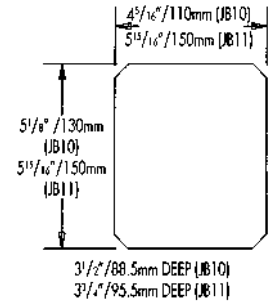

A range of GRP Terminal Boxes and Control Units. The Control Units can be fitted with a variety of lamps, switches, pushbuttons and other accessories.

## GHG 74 & 44 UL | Terminal Boxes & Control Units – Hazardous Locations



\*Model dependant

All specifications, dimensions, weights and tolerances are nominal (typical) and MEDC reserve the right to vary all data without prior notice. No liability is accepted for any consequence of use.

North American Certifications	<b>UL</b>		
Increased Safety	<b>Class I, Div 2, Groups A,B,C &amp; D Class I, Zone 1, Groups A,B,C &amp; D Class II, Div 1, Groups E, F &amp; G AExde IIC T4, T6*</b>		
Area Classification	<b>Model dependant - refer to datasheet</b>		
Ingress Protection	<b>IP65/66*</b>		
Material	<b>Corrosion-free GRP or 316 Stainless Steel</b>		
<b>Dimensions (mm):</b>			
<b>Box Type</b>	<b>Box Type</b>	<b>Width x Height x Depth*</b>	
444 23	744 01	271	134 136
448 23	745 02	271	271 136
449 23	746 02	544	271 136
471 23	749 04	817	271 136
444 33	744 21	175	312.5 151
448 33	745 22	312.5	312.5 151
449 33	146 23	312.5	312.5 151
447 33	749 24	941.5	312.5 151







- Globally certified with proven pedigree of service since 1975.
- Highest quality in-house design, certification and build.
- Highly specified by oil and gas companies world-wide.
- World leaders in signal and alarm notification products.
- Highest quality vertically integrated manufacturing.

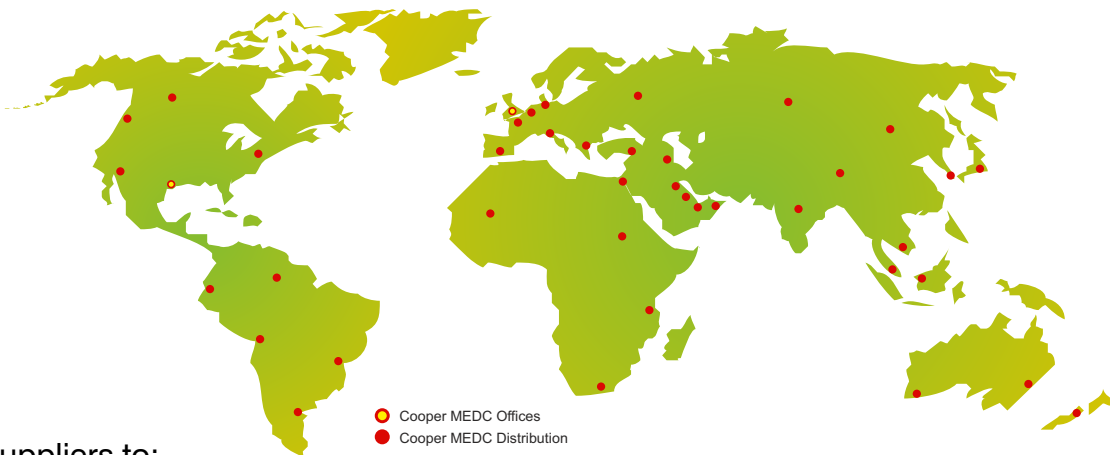

Suppliers to:



Cooper MEDC Ltd  
Colliery Road  
Pinxton  
Nottingham  
NG16 6JF  
United Kingdom

P: + 44 (0) 1773 864100  
F: + 44 (0) 1773 582800  
[www.medc.com](http://www.medc.com)

Cooper MEDC (USA)  
3413 North Sam Houston  
Parkway West  
Houston  
TX 77086  
USA

P: + 1 (713) 937 9772  
F: + 1 (713) 937 9773

Cooper Safety Ltd  
Jephson Court  
Tancred Close  
Royal Leamington Spa  
Warwickshire  
CV31 3RZ  
United Kingdom

P: + 44 (0) 1926 439 202  
[www.cooper-safety.com](http://www.cooper-safety.com)

Cooper Industries  
600 Travis, Suite 5600  
Houston, Texas 77002-1001  
P: 713-209-8400  
[www.cooperindustries.com](http://www.cooperindustries.com)